

How to make a Queen Wasp Trap

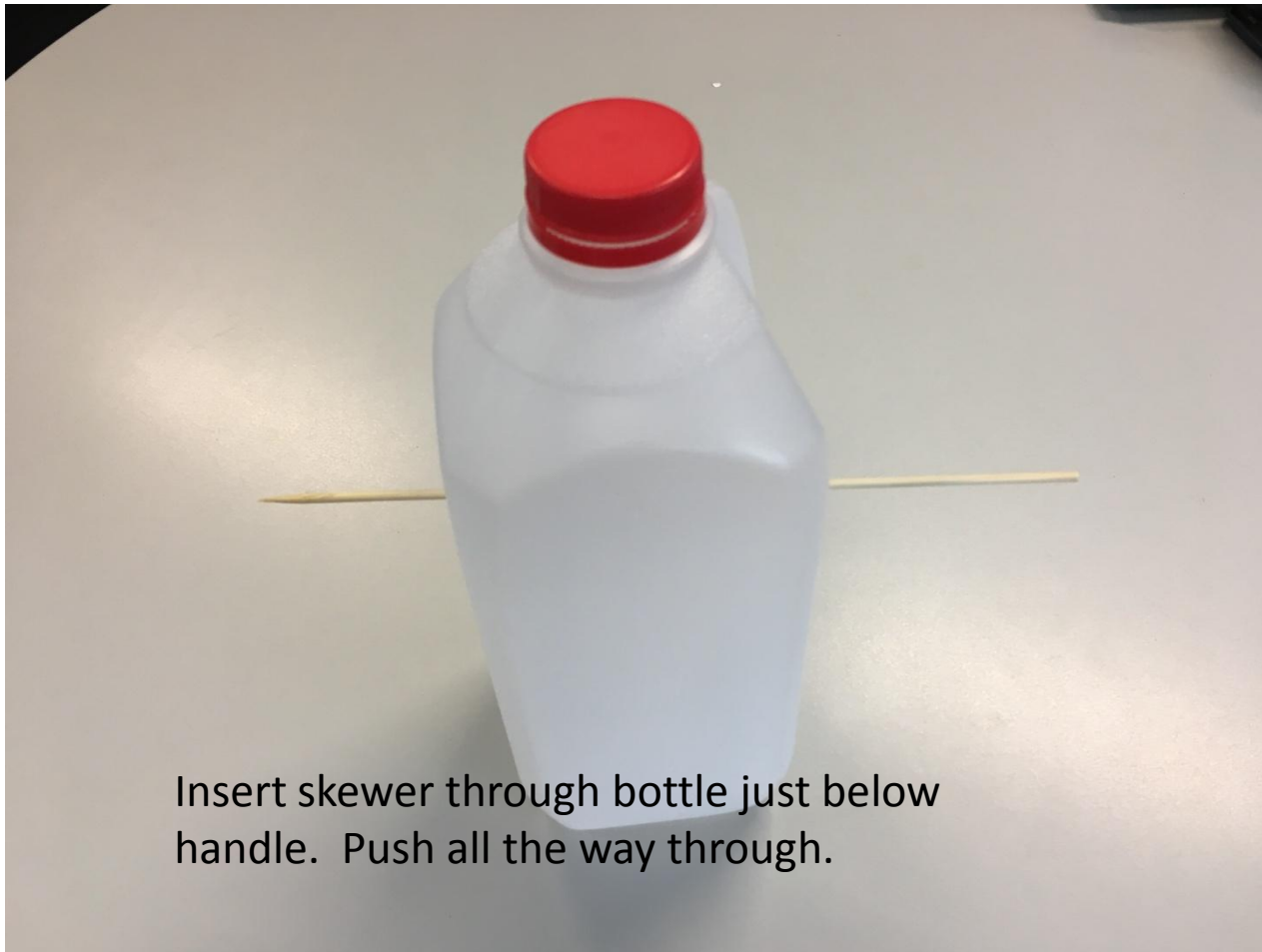

To make a Queen Wasp Trap you will need the following items. A milk bottle, skewer, Stanley knife and tape.

Step 1



Insert skewer through bottle just below handle. Push all the way through.

Step 2

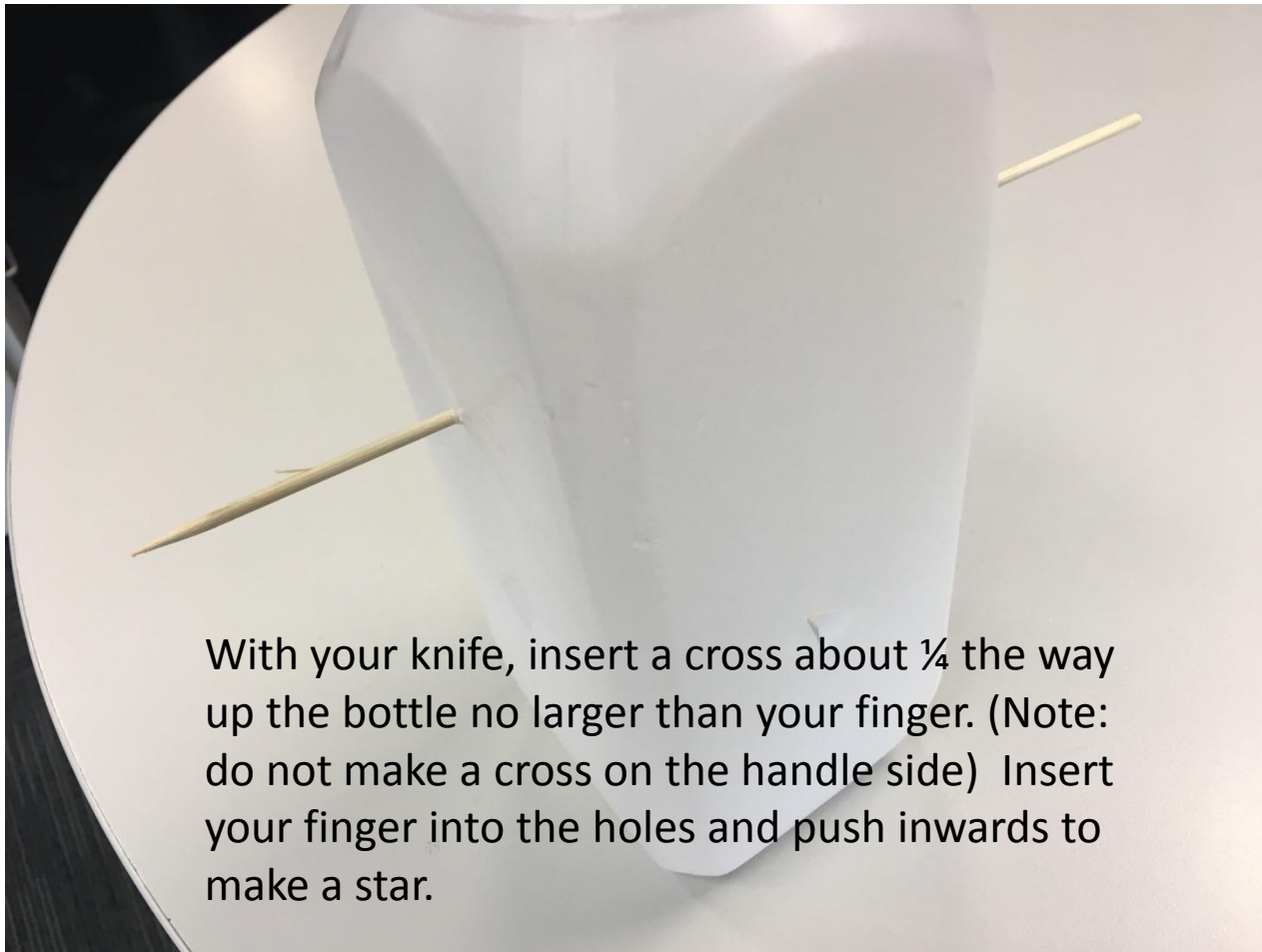

With your knife, insert a cross about $\frac{1}{4}$ the way up the bottle no larger than your finger. (Note: do not make a cross on the handle side) Insert your finger into the holes and push inwards to make a star.

Step 3

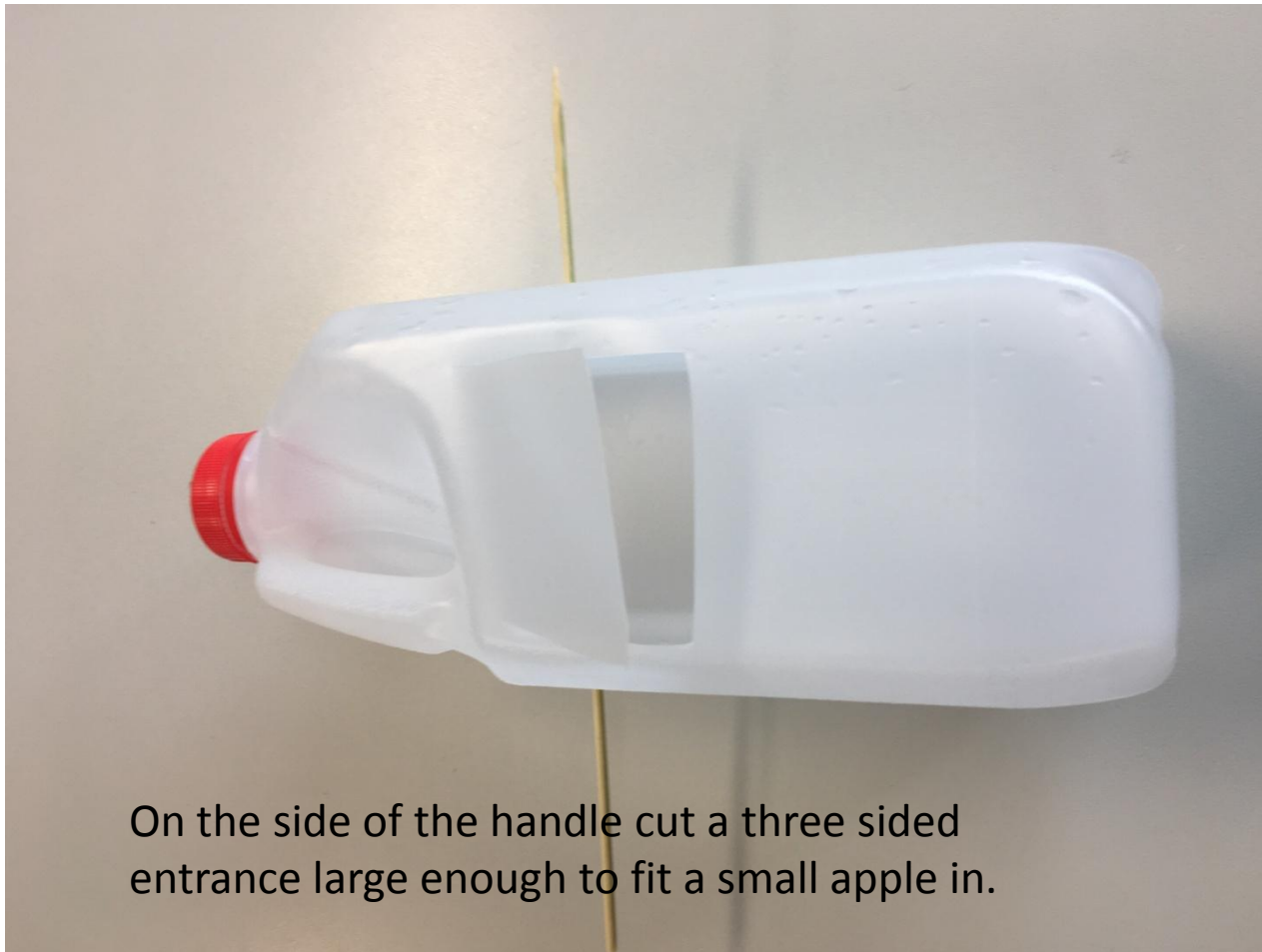

On the side of the handle cut a three sided entrance large enough to fit a small apple in.

Step 4

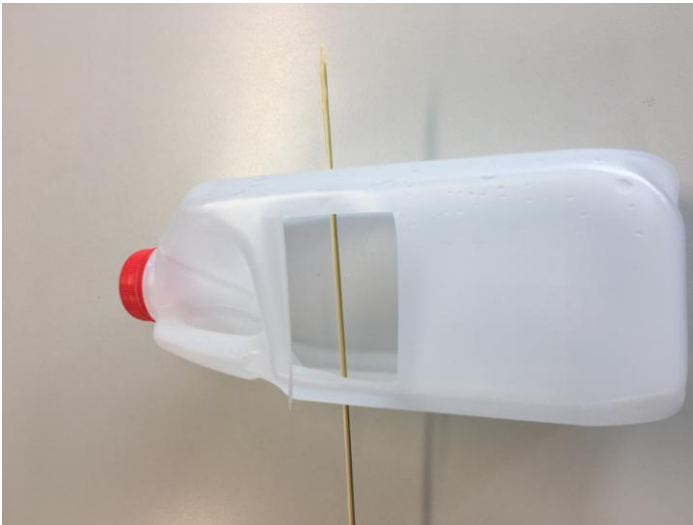

Fold back so you expose the skewer. With draw the skewer, place apple in bottle and push skewer back through so the apple has been secured inside the bottle. Stand bottle upright and in to the bottom add a small mix of vanilla essence, honey and jam. Just before placing into bottle, smear a small amount of this mix around the star holes on the inside. This will help attract the queen to enter through into the bottle.

Step 5

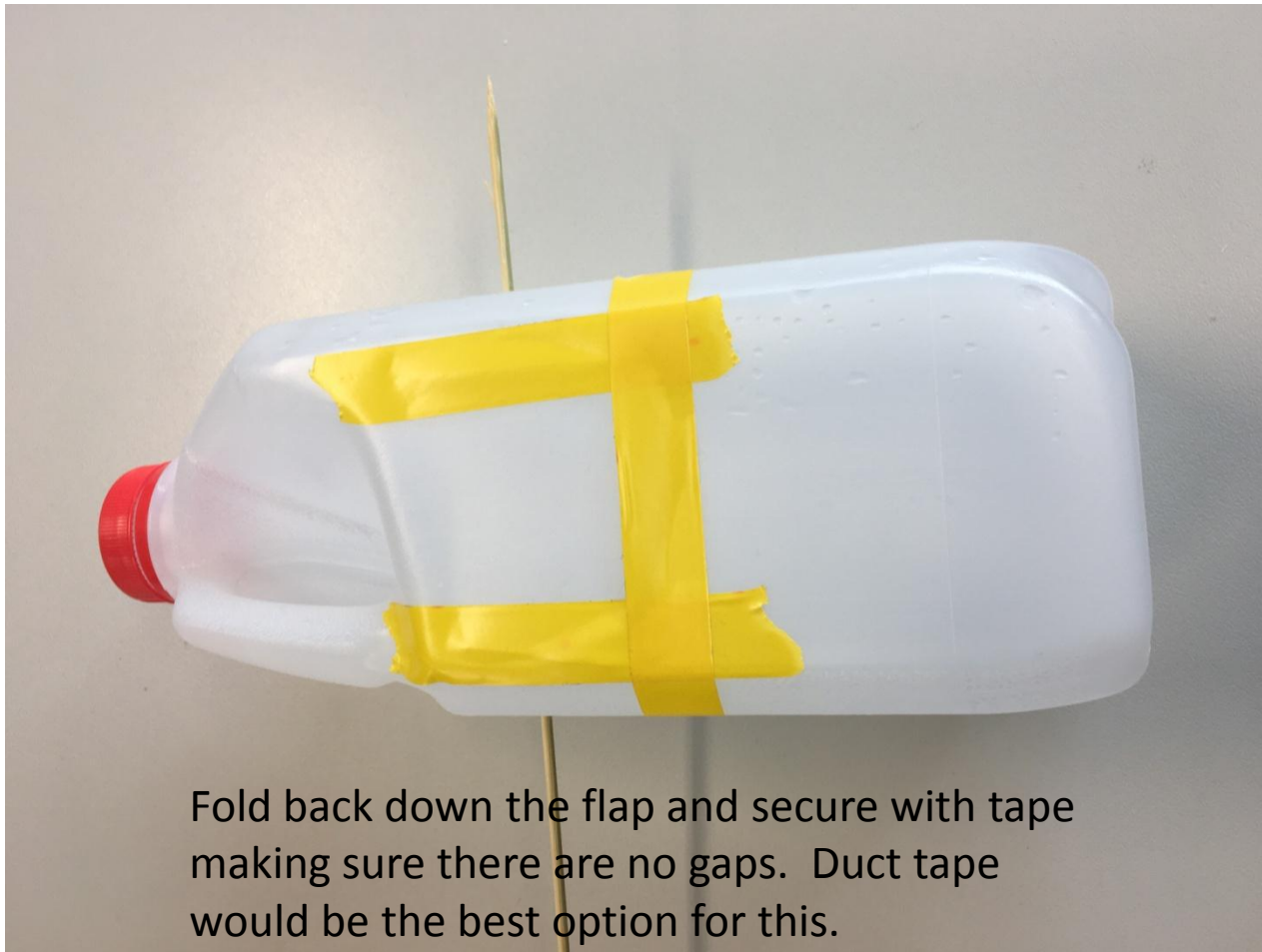

Fold back down the flap and secure with tape making sure there are no gaps. Duct tape would be the best option for this.

Step 6



Once all above steps have been undertaken, tie some string around the handle and hang off a tree branch. The queen wasps will be attracted by the sweetness of the apple as well as the honey, vanilla essence and jam.