

MINUTES/ FOLLOW UP ACTIONS – Economic Development Advisory Committee Meeting

**Reports
Encl 7.1**

Date	22 April 2013	Time	2pm – 4pm	Location	Council Chambers (Alexandra)	File number	58/04/02
Attendance	Cr Challen (Chair), Cr Walsh, Cr Derwent, Margaret Abbey, Michael Chesworth, Bob Elkington, Lisa Wallace (Minute secretary) Anne Leadbeater, Rob Black - Parks Victoria, Brad Quilliam - Kinglake Ranges Business Network (KRBN)			Apologies	Matt Parsons		

Meeting Objective Seek input and keep the advisory committee informed of key economic development initiatives

Item No	Description	Action	Who	Time
	Minutes of Previous Meeting:	Last meeting held in 26 July 2012 (minutes available on request)		
	Welcome and Terms of Reference (see attachment 1)	Cr Challen welcomed all to the meeting.		
1.	Guest Speaker – Brad Quilliam, KRBN 1. Update and discussion re progress of the Murrindindi Business and Tourism Association	Last two years been working collaboratively with LTA's with success. Streetlife grant of \$5K, with matching \$5K of MRTA funds – hope project to officially structure group in shire. Endeavour to reduce duplication of resources unify events, joint efforts to gain funds for project and resources. Need MSC to endorse structure. AL – a set plan of networking events will provide the opportunity to engage industry and other interested businesses. MC – change in focus from tourism to business – build process and those who aren't engaged. MA asked of the time frame for the networking session. AL explained that the funding will be expended by 30 October 2013 in compliance with the Street Life funding conditions. Networking events will be held in June/July to engage stakeholders, then evaluation of feedback and development of a strategic plan and resource plan.		

		<p>Access to other funding programs (e.g. RDV) will be strengthened with a clear strategy and resource plan in place. JW asked the aims of the network sessions? To identify a way forward, strengthen industry opportunities in the shire, one voice. CC enquired on the proposed structure AL – Have developed a structure (tabled) and draft terms of reference for the group. BQ – still a focus on LTA’s to assist with membership, etc – a two-way structure.</p> <p>2. Building Our Business Community Event Event flyer distributed to all present. Organisers wanting to support Economic Development – Workspace Australia to engage via MSC. Rotary have potential resources. Event details: 30 April 2013, Plenty Ranges Arts & Convention Centre. Over 100 registered to date, looking at possible annual event with industry and government together. Advertising well, have sponsors onboard and will provide evaluation forms on the night.</p> <p>3. Kinglake Ranges economic development document Attachment distributed to all present. Not over hurdle of safety – still work to be done. Via meeting with Deputy Premier Peter Ryan with presentation voice of KRBN and recovery. Commended and maturity, work with RDV, FRU, DPCD possible opportunities. Need partner’s i.e. Council re strategic plan. Had meeting with RDV on document, unfunded opportunities: 1 – Produce & Artisan market. Victorian Farmers Association criteria and registration under their banner – challenges are ways to strengthen other than traditional marketing. 2 – Tier event to qualify event strategy (provide funding) how to bring visitors and become a sustainable event. Creating solid events with multiple outcomes for the shire. Example, the Kinglake House of Bottles/Visitor Information Centre – another way of bus loads of visitors and direction of day visitors?</p> <p>4. Equestrian Centre Funds of \$30K business plan. Have pony club and adult riders. How will they manage the centre?</p> <p>5. Business events Business events – Marysville Chamber of Commerce work together on events.</p>		<p>Reports Encl 7.1</p>
--	--	--	--	---

2.	<p>Guest Speaker – Rob Black, (Parks Victoria)</p> <ol style="list-style-type: none"> 1. Update on the Toolangi Zipline project 2. Where to from here regarding advocacy 	<p>Bob introduced Rob Black and his background working on significant projects including the last couple of years working on the Zipline project. Originally 5 locations were considered for a guided canopy tour; 2 located in Toolangi. Toolangi State Forest's impressive stands of Mountain Ash, fern gullies and pockets of cool temperate rainforest make it an ideal location for a Guided Canopy Tour. It is also less than 1 ½ hours from Melbourne and a short drive from Healesville Sanctuary and the Yarra Valley. An Expression of Interest process by Australian Zip Line Canopy (AZCT) was conducted to investigate prior to AZCT developing a concept plan.</p> <p>Issues on the site consisted of 1) construction of the Zipline and 2) impacts on the environment when the Zipline is operating (e.g. Leadbeater possum). DSE decided not to progress the project. Next step is a letter to the Minister about regarding an alternate location close by which would be suitable and meet necessary requirements.</p> <p>Rob will: 1) Keep in contact with proponent, 2) contact Vic Forests 3) make/keep contact with Cindy McLeish, Louise Asher & Murrindindi Shire Council.</p>		<p>Reports Encl 7.1</p>
3.	<p>Murrindindi Training Demand Study</p>	<p>AL – Advancing Country Towns – Skills, Training and Workforce Development Initiative Part A involved the funding and production of the Plan For Growth Training Needs Analysis Report. Project funded through ACT, Regional Development Australia and the Central Ranges LLEN and project lead by CRLEN. Report launched in May.</p> <p>Available on Council's website and being printed and circulated to businesses and training providers who participated.</p> <p>Part B of the initiative has engaged Murrindindi Training Institute to develop a network of training providers, businesses, schools and other service providers to maximise employment and training opportunities within the shire. MTI take lead to identify and deliver on Plan for Growth recommendations.</p> <p>BE – consultants 400+ database handover to MSC to engage better.</p>		
4.	<p>Economic Development Strategy – Implementation Plan (see attachment 2)</p>	<p>Tabled and review for next meeting 24 June 2013.</p>		

5.	Council Plan – Our Economy	Discussion on content of <i>Our Economy</i> section (as distributed). MC to follow up.		Reports Encl 7.1
6.	Goulburn River Valley Tourism 1. Board representative handover 2. Activities update	Carried to next meeting.		
7.	Regional Victoria Living Expo report	<p>The Regional Living Expo was held 19-21 April at the Melbourne Exhibition Centre. All non-metro Councils in attendance. MSC attended and co-promoted our partner (Live Work & Invest) shires; Mansfield, Benalla, Strathbogie and Mitchell. Representatives by Eco Dev't staff (Lisa, Kat & Bob), Julie Blyth (contractor for event) and Ken Adams (interested local businessman from Marysville Caravan & Holiday Park). Very pleased with the outcome as follows:</p> <ul style="list-style-type: none"> • Increased numbers on last year (approx. 8,000 per day) • Over 500 info kits/showbags given out to interested parties • More genuine interest (i.e. no home show overflow) that last year • Approx. 80 individual responses generated from one to one discussions and more from interest expressed at the registration point • Key questions – employment opportunities, cost of housing/land, schooling options, travel time to Melbourne, potential to commute to Melbourne for work • Skills on offer included chefs, general administration, bookkeeping, skilled and semi skilled trades people, landscape gardening, financial and accounting/business support, office and commercial cleaning, home based IT/IT specialist, nursing and aged care workers/home based care. 		
8.	Central Ranges Local Learning and Employment Network (CRLLEN) membership update	Carried to next meeting.		

9.	<p>Other items:</p> <p>a) Marysville signage</p> <p>b) Investment attraction project updates (only if time permits)</p> <p>1. United Petroleum Kinglake 2. Mt Pinniger Resort Eildon 3. Kinglake Conference Centre 4. Marysville Hotel and Conference Centre 5. Marysville Micro Brewery</p>	Carried to next meeting.		Reports Encl 7.1
	Next Meeting:	Monday 24 June 2013		
		2013 Schedule: 26 August 28 October 23 December		

The Kinglake Ranges, Flowerdale and Toolangi Draft Plan and Design Framework Tables

Current status of Implementation Strategy Actions excluding
Direction 1 Actions which refer to Settlement Planning and Growth
June 2013

Key Direction 2 - Ensure a Viable Local Economy

The Kinglake Ranges, Flowerdale and Toolangi region needs to provide sufficient levels of employment, services and business opportunities to support the livelihood and wellbeing of local communities, recognising that as part of Melbourne's hinterland, these communities also benefit from close proximity to employment and services in the metropolitan area.

Local economic development should harness, protect and enhance those factors that give the region its competitive advantage including fertile soils and farming land, tranquil rural townships, natural beauty, environmental values, and self-reliant and creative people.

A more sustainable future will embrace opportunities in the new green economy based around greater self-sufficiency, new agri-business and tourism that draw on the natural assets of the region including the Kinglake National Park and highly productive agricultural land.

Action		Timing	Rationale	Lead Agency	How will this be achieved	Implements Strategies	Current Status/ Work Completed to Date
A2.1	<p>Establish a brand identity for the study area which captures the strengths and advantages of the region such as the natural and recreational values of the area - (e.g. "Melbourne's playground of the north".)</p> <p>The brand identity must be consistent with the core values held by the community</p>	Medium Term	<p>A brand identity can contribute to economic development through promoting tourism visitation and the sale of local produce</p> <p>The Kinglake National Park will continue to generate the highest visitation</p>	<p>Murrindindi Shire Council</p> <p>Tourism Victoria</p> <p>Kinglake Ranges Tourism and Business Association</p> <p>Goulburn River Valley Tourism</p> <p>Parks Victoria</p>	Council's Economic Development Strategy	1.2, 2.1, 2.2, 2.3, 2.4, 2.5, 3.4.	<p>No action taken by Council to date.</p> <p>Need to consider the cost and implications of creating and promoting a unique brand for the study area, given work undertaken to date to promote the broader attractions of "Murrindindi" as a region.</p> <p>Focus could be on area specific marketing/promotional features within context of overall regional marketing initiatives</p> <p><u>Recommendation</u></p> <p>Re-frame action to create feature marketing initiatives within existing mediums (OVG, GRVT etc)</p>
A2.2	<p>Support improved infrastructure, including high speed internet to support small, creative and innovative businesses</p>	Medium Term	<p>Small, creative and innovative businesses are consistent with the core values expressed by residents and will provide opportunities for local residents to stay on the mountain.</p>	<p>Murrindindi Shire Council</p> <p>Federal Government</p>	Lobby the National Broadband Network Co. and telecommunications providers to provide improved infrastructure to the area	2.2, 2.5, 5.3, 7.2	<p>Council has made representation to the Federal Government to seek improved outcomes for Murrindindi, including the study area, with respect to the provision of telecommunications/broadband services.</p> <p>NBN Fibre rollout to commence in area of Kinglake to Kinglake West within 3 years. Fixed wireless roll out in areas adjoining Kinglake is also scheduled in next three years.</p> <p><u>Recommendation</u></p> <p>Action to remain with a shire-wide focus, not specific to KR</p>

<p>A2.3</p>	<p>Improve the tourist offer through:</p> <ul style="list-style-type: none"> • Linking settlements directly, or by way of information, with improved tourist facilities in the Kinglake National Park promoting towns as gateways to the National Park (for example, Visitor Interpretative Centre, Visitor Information Boards in settlement nodes, viewing platform at Mt Sugarloaf, downhill Mountain bike course, improved walking trails) • Improved road cyclist infrastructure including mileage markers and signage on mountain climbs approaching study area (Humevale Road and Heidelberg – Kinglake Road) • Establish tourist walking/cycling and driving routes that guide visitors to local attractions • Improved park visitor facilities (improved picnic area at masons falls) 	<p>Short Term</p>	<p>Existing links between settlements and the natural assets of the region are fragmented and uncoordinated.</p> <p>Alignment of key settlement linkages with natural assets will provide for better integration and synergies for settlements and local communities.</p>	<p>Murrindindi Shire Council</p> <p>Whittlesea and Nillumbik Councils (cyclist infrastructure)</p> <p>VicRoads</p> <p>Tourism Victoria</p> <p>Parks Victoria for Kinglake National Park facilities</p>	<p>Kinglake National Park Masterplan</p> <p>Council capital works budgets (signage)</p>	<p>2.1, 2.4, 3.5, 5.1, 5.4, 7.1, 7.3</p>	<p>Council has supported the Kinglake Ranges Business Network with financial input and content advice and editing in relation to one refurbished and six new visitor information boards across the Kinglake Ranges.</p> <p>Through 2012 Parks Victoria has progressed restoration and improvement works at a number of sites identified as priorities in the Kinglake National Park Masterplan, including:</p> <ul style="list-style-type: none"> • Masons Falls. • Jehosaphat Gully. • Bowden Spur Mountain Bike Trail. <p>Additional works identified in the Masterplan will be progressed by Parks Victoria as funding becomes available.</p> <p><u>Recommendation</u></p> <p>Action to remain as ongoing action to improve tourism offerings through appropriate infrastructure as resources become available</p>
<p>A2.4</p>	<p>Support the re-establishment of a petrol station in Kinglake</p>	<p>Short Term</p>	<p>Residents have no choice but to travel off the mountain to purchase fuel. This contributes to the leakage of retail expenditure. A permanent petrol station in the study area would help to limit trade leakage</p>	<p>Murrindindi Shire Council</p>	<p>To be determined</p>	<p>4.3</p>	<p>Temporary fuel station has been in operation in Kinglake for two years on land leased by Council and with support of the FRU.</p> <p>Council has continued to facilitate opportunities for the re-establishment of permanent facilities and is currently in discussion with a potential developer/operator.</p> <p><u>Recommendation</u></p> <p>Action likely to be achieved with current development proposal – delete from strategy upon confirmation of planning and building approvals</p>

A2.5	Undertake a detailed study to determine the rate of breakdown of Dieldrin in soils within the study area in order to better understand longer term production issues including for organic farming	Short Term	<p>The presence of Dieldrin in soils places limitations on what it can be used for (growing of certain crops, grazing of livestock) and for certification of organic farming</p> <p>There is limited knowledge as to how long it will be before Dieldrin concentrations in the study area are naturally reduced to the point where limitations on land use will be reduced / totally removed</p>	Department of Primary Industries	Detailed environmental study	1.2, 2.2, 2.3.	<p>No action taken by Council to date.</p> <p>DEPI is the lead agency</p> <p><u>Recommendation</u></p> <p>Seek advice from DEPI if this is likely to be undertaken. If not, delete from strategy.</p>
A2.6	Include the study area in relevant agribusiness development programs run by DPI	Short Term	The high quality soils and high rainfall of much of the study area presents opportunities for agribusiness to establish in the study area	Department of Primary Industries	Agfutures Program	1.2, 2.2, 2.3.	<p>No action taken by Council to date</p> <p>DEPI is the lead agency</p> <p><u>Recommendation</u></p> <p>Seek advice from DEPI if this is likely to be undertaken. If not delete from strategy.</p>
A2.7	Explore opportunities for agriculture related tourism such as farmgate sales and farmers market	Short - Medium Term	The highly productive agricultural land within the study area and the proximity to Melbourne provide opportunities for agriculture related tourism	Murrindindi Shire Council Tourism Victoria	Council's Economic Development Strategy	2.2,2.3	<p>No specific action taken by Council in the study area, however Council has made comment/submission to the Minister for Planning in relation to the potential revisions to the farming zone to provide opportunities for tourism/agriculture uses.</p> <p>The Kinglake Framers Market has been established, with funding support provided by RDV.</p> <p><u>Recommendation</u></p> <p>Action partly completed, reframe action on promotion of opportunities subject to outcomes of the Farming Zones review.</p>
A2.8	Review the appropriateness of the Farming Zone provisions as they apply to small lots within the study area located outside of recognized settlements (following Government review of planning	Short - Medium Term	The application of the Farming Zone to small lots within the study area that are located outside of recognized settlements is problematic as many of these lots are too small to	Department of Planning and Community Development	Murrindindi Planning Scheme	1.4, 2.2	<p>The Council is awaiting the outcome of the Ministerial review of planning zones.</p> <p>DPCD is the lead agency</p> <p><u>Recommendation</u></p>

	zones)		be used for productive agriculture The Farming Zone does not reflect the use of these lots and places limitations on their use and development				Action remains, subject to review of Farming Zones by the State
--	--------	--	---	--	--	--	---

Key Direction 3 - Protect and Enhance the Environment

The Kinglake Ranges, Flowerdale and Toolangi region features highly valued natural landscapes and areas of environmental significance that must be protected and restored. These features directly and indirectly influence all activity in the region and are its strongest asset. This is reflected in the high level of community awareness about the importance of the local environment.

The natural landscape attracts residents and visitors alike and distinguishes this region from any other, but it is facing significant challenges. The ecological restoration process following the bushfires is underway but will take many years.

External pressures such as climate change and urban and agricultural land uses present critical challenges to the environmental values of the area. There is a need to focus on improving the resilience of the environment to face these challenges while allowing for the necessary interaction between the community and the environment.

Action		Timing	Rationale	Lead Agency	How will this be achieved	Implements Strategies	Current Status/ Work Completed to Date
A3.1	<p>Re-cast the townships as gateways to the natural assets of the area through improved signage and way finding</p> <p>Undertake a retail development strategy specifically for the study area to realise the potential for eco-tourism related expenditure</p>	Medium Term	<p>The settlements of the Kinglake Ranges should be re-cast as gateways to the natural assets of the area.</p> <p>The high numbers forecast for future visitation of the Kinglake National Park present an opportunity to provide tourists with a logical pathway to stop in the townships and for local business to earn revenue from retail activities.</p>	<p>Murrindindi Shire Council</p> <p>Parks Victoria</p> <p>Tourism Victoria</p>	<p>Prepare a wayfinding strategy to improve signage and way finding.</p> <p>Implement the recommendations of the Design Frameworks through Councils capital works program.</p>	2.1, 2.5, 7.1.	<p>New Shire and Town Entry signage has been installed by Council in the study area following the loss of signage during the fires.</p> <p>Council in discussion with potential developer of retail premises in Kinglake township.</p> <p>No other action taken to date.</p> <p><u>Recommendation</u></p> <p>Action requires partnership with Parks Victoria. Action to remain as is.</p>
A3.2	<p>Monitor outcomes from the Yarra Valley Water Kinglake West demonstration project and apply relevant learnings elsewhere in the study area</p>	Medium - Long Term	<p>The environmental impacts of effluent entering waterways are significant and need to be addressed particularly in locations such as Flowerdale and</p>	<p>Murrindindi Shire Council</p> <p>Department of Planning and Community Development</p>	<p>Murrindindi Planning Scheme (for new development proposals that generate waste water).</p> <p>Council's role in</p>	3.2, 3.4.	<p>It will be some time before proper evaluation can be undertaken to assess the effectiveness of the project and to apply these learnings elsewhere.</p> <p>It is unlikely that this sewerage treatment system will be replicated in areas such as Kinglake township, Flowerdale or Hazeldene in the near future unless</p>

			Hazeldene with houses in close proximity to the King Parrot Creek.	Department of Sustainability and Environment Environment Protection Authority	Environmental Health management.		funded by government. Although Council made representation on this issue, the opportunity to pursue innovative approaches to waste water management in the study area was not pursued by Government as part of the bushfire rebuilding program. <u>Recommendation</u> Lead agency unclear. Unlikely to be able to apply learning elsewhere in study area due to cost of infrastructure required. Action needs to be reframed to reflect an advocacy approach.
A3.3	Undertake technical assessments of the wastewater treatment system installed as part of the Kinglake temporary village to ascertain its level of performance and ability to support development in the long term	Short Term	The waste water system is a significant government investment and may provide an opportunity for retrofit commercial centre.	Murrindindi Shire Council Environment Protection Authority	Council in conjunction with the EPA undertake the assessment.		Decision was made by Department of Human Services to decommission the system as part of the decommissioning of the temporary village. Major components of the effluent disposal infrastructure remain in-situ at the Village site . It is unclear if the site will be supported by the government (Minister for Planning) for future development. It is also unknown whether the existing infrastructure located at the village may provide a future servicing option for the existing Kinglake Township and its potential expansion <u>Recommendation</u> Subject to advice from the State Government with respect to development likelihood.
A3.4	Work with the EPA to evaluate improved onsite wastewater disposal solutions that are affordable and reduce environmental and health risks	Medium - Long Term	Outdated and poorly maintained onsite waste water systems are leading to environmental degradation and potential health risks in a number of settlement locations.	Murrindindi Shire Council Environment Protection Authority	Council to continue engagement with the EPA		Council has worked with landowners as part of the rebuilding program to encourage septic tank system upgrades, which has resulted in improved wastewater management outcomes in the study area. There has been no specific action taken in relation to septic tank upgrades on existing dwellings in study area. <u>Recommendation</u> Refer action to Council's Waste Water Strategy. Not specific to Kinglake Ranges
A3.5	Promote further education within the community on the environmental impacts and health risks associated	Long Term	Better maintenance of individual on site waste water systems is a land holder	Murrindindi Shire Council	Council communication with residents		Council has increased its resources to improve monitoring of septic systems in the Shire

	with run-off from septic tanks entering waterways and groundwater		responsibility.				<p><u>Recommendation</u></p> <p>Refer action to Council's Waste Water Strategy. Not specific to Kinglake Ranges.</p>
A3.6	Pursue funding for a reticulated waste water treatment system for Hazeldene and Flowerdale and other settlements within the study area	Medium – Long Term	<p>The environmental and health benefits from retrofitting existing settlements with wastewater treatment systems are significant.</p> <p>Hazeldene and Flowerdale have been identified as the highest priorities for a reticulated system given lot sizes and proximity to the King Parrot Creek.</p>	Murrindindi Shire Council	Engagement with relevant water authorities	3.1, 3.2	<p>No specific action taken by Council to date</p> <p>It is unlikely that a reticulated waste water treatment system will be implemented in areas such as Kinglake township, Flowerdale or Hazeldene in the medium term (if at all) due to prohibitive infrastructure costs.</p> <p>Despite Council representation on this issue, the opportunity to pursue this approach was not pursued by the Government as part of the bushfire rebuilding program.</p> <p>Council has worked with landowners as part of the rebuilding program to encourage septic tank system upgrades, which has resulted in improved wastewater management outcomes in the study area.</p> <p><u>Recommendation</u></p> <p>Funding unlikely due to the cost involved. Reframe action to an advocacy role or delete.</p>
A3.7	Establish biolinks (habitat corridors) between forested land	Medium-Long Term	Provide safe and protected habitat corridors will maximise the movement and migration of fauna and the viability of flora	<p>Murrindindi Shire Council</p> <p>Department of Sustainability and Environment</p> <p>Parks Victoria</p>	To be determined	3.1	<p>No action taken to date By Council.</p> <p>Council unlikely to be a lead agency in this issue.</p> <p><u>Recommendation</u></p> <p>Confirm alignment with DEPI principles / strategies, if no alignment or specific action likely, delete.</p>
A3.8	Undertake detailed modelling of the Kinglake Groundwater Management Area to better understand the aquifer and quantity of water that can be extracted sustainably and inform the development of a Groundwater Management Strategy Communicate to the community the facts	Short Term	Groundwater is an important resource to farmers and residents within the study area. A better understanding of the aquifer and a consequent management strategy will ensure that its long term sustainability is	Goulburn Murray Water	Groundwater Management Strategy for the Kinglake Groundwater Management Area	3.1, 3.2	<p>GMW is in the process of reviewing its Ground Water Management Plan for the study area (particularly Kinglake).</p> <p>Water licensing for commercial/irrigation ground and surface water will remain capped in study area.</p> <p>GMW is lead agency</p> <p><u>Recommendation</u></p> <p>Action being implemented by GMW. Suggest reframe action to provide ongoing community</p>

	regarding sustainable groundwater use in the region		ensured.				information/education on the matter.
--	---	--	----------	--	--	--	--------------------------------------

Key Direction 4 - Create Attractive, Distinctive and Vibrant Towns

Local towns provide the services and businesses that meet the daily needs of local communities and support rural lifestyles. Having evolved with different histories and for different reasons, linked to farming, forests or the Kinglake National Park, each town in the study area contributes strongly to a sense of place and community identity for local residents. In recent years, they have also offered lifestyle and affordable housing choices close to Melbourne. However, in some instances, the decline of farming, along with fragmented patterns of development, has detracted from the attractiveness, function and viability of these townships.

Attributes that should be strengthened through the Plan and Design Framework include:

- local township identity and sense of place
- distinctive cultural heritage
- unique natural settings
- the right mix of businesses and services that support viable towns and local settlements.

Action		Timing	Rationale	Lead Agency	How will this be achieved	Implements Strategies	Current Status/ Work Completed to Date
A4.1	Remove the inconsistencies between locality boundaries recognised by existing signage, Government agencies (i.e. Australia Post) and local residents understanding of locality boundaries	Short Term	The identity issue has been raised by many residents. This issue is widespread in many areas such as Kinglake West/Pheasant Creek, Hazeldene and Flowerdale and Toolangi and Castella.	Murrindindi Shire Council Department of Planning and Community Development	Through the process outlined in the Guidelines for Geographic Names 2010	4.4	A preliminary review to confirm current official boundaries between Kinglake West / Pheasant Creek and Castella / Toolangi has been undertaken by Council. <u>Recommendation</u> Action to remain
A4.2	Implement design frameworks prepared as part of this study to improve the attractiveness and functionality of settlements within the study area. This should also include protection of significant views, vistas and the establishment of landscape buffers	Short – Long Term	Improving the attractiveness of settlements via the creation of logical nodes and meeting places will benefit both residents and the overall viability of settlements.	Murrindindi Shire Council	Recognise the Design Frameworks contained in this document in the Murrindindi Planning Scheme.	1.1, 1.3, 4.1, 4.2, 4.3, 4.4, 5.1.	No action taken by Council to date. Further work is needed to develop the design frameworks prior to implementation. This specific piece of work can be progressed subject to DPCD and Council agreement on funding, expected outcomes and timelines. <u>Recommendation</u> Action to remain

A4.3	Develop and implement design guidelines to ensure that new development within the study area does not compete or detract from its natural landscape setting	Short – Long Term	The unique landscape setting of the study area should not be impacted upon by new development. It is generally accepted that built form contributes to (or can detract from) the character and identity of a place.	Murrindindi Shire Council	Recognise the Design Frameworks contained in this document in the Murrindindi Planning Scheme.	1.1, 4.2.	Not possible to reference or incorporate the study into the Murrindindi Planning Scheme until such time as the study is completed and officially adopted by Council. Comment as per A4.2 <u>Recommendation</u> Action to remain
A4.4	Improve identity through a comprehensive Way Finding strategy which includes urban design elements such as community nodes, civic hubs, pathways, gateways and entry features and varied public open spaces	Short Term	The legibility of individual settlements and the presentation and identity of the region as a whole will benefit from a coordinated approach to linkages, presentation and information.	Murrindindi Shire Council	Prepare a wayfinding strategy to improve signage and way finding.	2.1, 2.5, 7.1.	Action similar to A3.1 No action taken by Council to date on developing a Wayfinding Strategy. Comment as per A4.2 <u>Recommendation</u> Action to remain

Key Direction 5 - Support the Wellbeing of Local Communities

Wellbeing is influenced by the social, economic and physical environments in which we live and the way we interact with those living conditions. Wellbeing is not just about being healthy or sick, but about the quality of our lives and our communities.

This Plan seeks to support and enhance:

- the services, facilities and amenity of each township that will enable community wellbeing to flourish
- the capacity of groups and individuals to initiate community activities and participate in community life
- the resilience, safety and sense of belonging of all residents.

Action		Timing	Rationale	Lead Agency	How will this be achieved	Implements Strategies	Current Status/ Work Completed to date
A5.1	<p>Ensure access to well-located base-line community infrastructure in each settlement, including; community meeting space, local open space and play facilities and community information (including access to information technology)</p> <p>Community infrastructure should be co-located (e.g. Clustering of community facilities) and adjacent to public transport where available</p>	Medium Term	<p>All communities should have access to flexible community infrastructure which supports the needs of all ages and can respond to changing needs over time. Emphasis should be placed on the capacity and sustainability of walkable local facilities.</p>	Murrindindi Shire Council	<p>Working with local service providers and residents in each settlement to respond to the findings of the Community Wellbeing Issues Paper.</p> <p>Adopting locational criteria for the provision of any future facilities.</p>	5.1 5.2 5.3	<p>Through the Bushfire Recovery response a significant amount of new or enhanced community infrastructure has been built (or is near completion) across the study area pertaining to health/medical services, recreational, youth space, open / play space and multi –use meeting space needs.</p> <p>Co-location has been sought where-ever possible to create hubs of activity (eg. Kinglake municipal offices and library with medical centre and play space. Kinglake Central new school, early learning centre, play space , senior citizens and recreation reserve. Flowerdale school, early learning Centre, youth facility, community meeting space etc).</p> <p><u>Recommendation:</u></p> <p>Action to remain as a principle guiding future provision of community infrastructure.</p>
A5.2	<p>Develop local open space and play opportunities in each settlement catering for a range of ages and interests, supporting the role of local open space for community gathering and informal recreation</p>	Medium – Long Term	<p>Supporting the role local open space plays in providing opportunities for physical activity and social interaction</p> <p>Local open space and play opportunities should be developed for settlements that lack these, particularly</p>	Murrindindi Shire Council	Preparation and implementation of Open Space Strategy.	5.1 5.2 5.3 5.4	<p>Several open space projects have recently been completed in the Study Area including Castella Park, Bollygum Adventure Park, Kinglake Memorial Reserve re-development, Kinglake Lions Park re-development, Kinglake West Reserve Reflective gardens, Flowerdale Community House playspace, Moores Rd playspace Flowerdale, Spring Valley Recreation Reserve sporting and facility enhancements.</p>

			at Flowerdale/Hazeldene and Kinglake				Unlikely to be further development of facilities in the short to medium term. <u>Recommendation</u> Action to remain as a principle guiding future provision of community infrastructure.
A5.3	Identify opportunities to improve walking and cycling access within townships, as well as links to Kinglake National Park and State Forest	Medium – Long Term	Strong interest in supporting physical connections between towns and optimising the health benefits of physical activity	Murrindindi Shire Council	Preparation and implementation of Active Transport Strategy	5.1	No specific strategy work has been undertaken by Council, although several pathways have recently been constructed (see A7.2) Parks Victoria is also a key agency. <u>Recommendation</u> Action to remain.
A5.4	Continue to explore opportunities with the Department of Education and Early Childhood Development (DEECD) to identify a sustainable model for post-Primary education to be provided in the study area (e.g. Primary to year 9)	Medium – LongTerm	The research and consultation process identified the potential role of secondary education in supporting young people to maintain their social connections and support networks in the local area and to reduce long daily commutes for children	Murrindindi Shire Council Department of Education and Early Childhood Development	Formation of "Post-Primary Education Options" Working Group.	5.1 5.2 5.5	No recent action taken by Council. DEECD has advised that there are no specific short to medium term plans to provide post-primary education in the Study area. Currently there is concern of impacts on existing secondary schools in the region <u>Recommendation</u> Action to remain but highlighting the longer term nature of the issue.
A5.6	Permanent consulting rooms should be constructed in the Kinglake Ranges to enable provision of GP services and other complimentary health and allied health services Rural Workforce Agency of Victoria to assist with the procurement of permanent general practice services to operate from the consulting rooms at the level determined by assessment of community need	Short Term	The study area needs to build its capacity to respond to models of health service delivery which are based on the flexible delivery of services where they are most needed and to support service coordination and cross-referral. The current administrative reference north to the Hume region is at odds with the natural service usage patterns of this peri-urban community back towards Melbourne	Federal Government Department of Health Rural workforce Agency of Victoria	Pending	5.2, 5.5	Permanent medical facilities (GP Consulting rooms) have now been constructed in Kinglake on Council land adjacent to the Council offices. Mitchell Community Health operate the medical facilities and provide GP services. <u>Recommendation</u> Delete action due to its completion.

A5.7	Prepare an Arts and Cultural strategy to identify ways in which arts and cultural activities contribute to the economic and social wellbeing of local communities and to guide investment in the development of arts and cultural facilities	Short Term	Arts and culture enriches the local communities and strengthens social fabric	Murrindindi Shire Council	Development and implementation of an Arts and Cultural Strategy	5.4	Council has recently developed an Arts and Culture policy for the municipality which describes Council's roles as a supporter and facilitator of arts and culture initiatives, but not a driver or provider of such. <u>Recommendation</u> Reframe action to support community initiatives aimed at developing arts and cultural opportunities.
A5.8	Work with local primary schools to enhance community use of facilities out of school hours	Immediate	There has been considerable investment in infrastructure for primary education, this project has identified the opportunity to optimise the value from this investment by ensure the facilities with primary school are made available to the wider community	Murrindindi Shire Council Department of Education and Early Childhood Development	MOU between Council and primary schools	5.1, 5.2, 5.5	No specific action taken by Council to date, other than the formation of joint use agreements where Council has a financial interest in the facilities (Marysville, Kinglake Central and Flowerdale). DEECD would need to be the driver. <u>Recommendation:</u> Confirm current position/direction of DEECD on this issue and revise action or delete as appropriate.
A5.9	Work with training providers to offer targeted vocational training to support employment pathways for young people (e.g. Hospitality training) and those returning to work.	Medium - Long Term	The project has identified demand for vocational training from local businesses and individuals to improve employment skills and capacity	Education & training providers. Murrindindi Shire Council	Identify funding for a training needs assessment to be undertaken in association with local employers	5.2, 5.5	Council has recently worked with the Local Learning and Employment Network in the conduct of a Training Demand Study across the municipality, including the Study Area. The outcomes identify current skill and training gaps and opportunities to address the gaps. <u>Recommendation</u> Reframe action to focus on implementation of actions of the recent study that are relevant to the study area.
A5.10	Provide on-going support and training for community volunteers	Medium - Long Term	The nature of community activity and community service provision in the study area requires on-going support to the volunteers who provide these activities	Murrindindi Shire Council Department of Planning and Community Development Community organisations		5.2, 5.3	Council continues to provide ongoing support and training to volunteers assisting within Council run programs in the area. Other key organisations utilising volunteers in the study area include Berry Street and Catholic Care, these organisations have Volunteer Coordination resources to assist in the provision of training and ongoing support. DHS is currently developing a model whereby three or four agencies will provide a qualified

							<p>clinician on a rostered basis to provide support to community leaders who themselves are relied upon by 'in need' community members.</p> <p><u>Recommendation</u></p> <p>Action remains as is</p>
A5.11	<p>Identify opportunities to increase whole-of-life participation in recreation opportunities (e.g. Age-appropriate programming of recreation facilities)</p>	Immediate	<p>There has been considerable investment in recreational infrastructure, this project has identified the opportunity to optimise the value from this investment by ensuring recreation facilities are welcoming and appropriate to all ages and interests</p>	<p>Murrindindi Shire Council</p> <p>Community Organisations</p>	<p>Audit of current usage of recreation facilities</p>	5.2, 5.5	<p>No specific action undertaken recently in the study area.</p> <p>In the 2013/2014 year the Council will be reviewing its recreation strategy and it is envisaged whole-of-life participation in recreation will be a significant theme.</p> <p><u>Recommendation</u></p> <p>Action remains as is</p>
A5.12	<p>Identify opportunities for regular information exchange between council, service providers and local residents (e.g. On-line forums, regular community meetings)</p>	Medium Term	<p>Service provision is dispersed across the study area, with fragmented access to information</p>	<p>Murrindindi Shire Council</p> <p>Community Service Providers</p>	<p>Audit of existing information strategies</p>	5.3	<p>A Council representative currently attends the Kinglake Ranges Service Collaborative Meetings.</p> <p>These meetings provide a platform for information sharing and action amongst funded community service organisations providing both bushfire specific services and ongoing generic services. Membership to the Kinglake Ranges Community and Services Collaborative includes 21 Community Service Organisations, Local, State and Federal Government department representatives and local community members. The Department of Human Services has funded a project officer to assist in the development of a plan for the group as well as funding for venue and catering for monthly meetings until December 2012.</p> <p>Many of the agencies involved in the Kinglake Collaborative are partners of the local Primary Care Partnerships (PCPs). PCPs are funded to improve access to services and continuity of care for people through improved service coordination, as well as chronic disease prevention, integrated health promotion, and partnership development. The majority of service providers in the Kinglake, Flowerdale and Toolangi area are also members of the Murrindindi Community Services Network. These meetings and membership lists provide a good framework for distribution of information.</p>

							<p><u>Recommendation</u></p> <p>Action to remains as is</p>
A5.13	Investigate opportunities for the development of community enterprises which support local economic and employment opportunities (e.g. Food co-op, coordinated marketing of local businesses, cultural initiatives, community events)	Medium-Long	During the course of this study there has been considerable interest in developing community enterprise opportunities which build on local strengths, increase local economic activity and generate local jobs	Murrindindi Shire Council Department of Planning and Community Development	Identification of funding for a community enterprise strategy	5.5	<p>Council officers are currently working with the North East Community Initiatives Ltd, based in Kinglake, on the development of a social enterprise around recycling and waste management and aimed at providing employment opportunities for unemployed youth.</p> <p><u>Recommendation</u></p> <p>Action to remain as is</p>
A5.14	Work with young people to provide on-going support for information access and social opportunities	Short Term	Social and recreational opportunities for young people have been identified as a priority during this project	Murrindindi Shire Council Department of Planning and Community Development	On-going consultation with young people	5.1, 5.2, 5.5	<p>The Murrindindi Youth Strategy is aimed at the needs of young people across the Shire. The Youth Partnership Group have provided funding to resource Youth workers in the Kinglake Ranges area and the Coordinator Youth Development is working closely with Allimata Youth Group to assist in the development of a sustainable and successful youth space in Kinglake.</p> <p><u>Recommendation</u></p> <p>Action to remain as is</p>
A5.15	Identify an accessible location (co-located with other support services and transport) as a focus for young people in the study area	Short Term	Social and recreational opportunities for young people have been identified as a priority during this project	Murrindindi Shire Council Department of Planning and Community Development	Audit of the capacity & suitability of existing infrastructure to accommodate the needs of young people	5.1, 5.2, 5.5	<p>As per A5.14</p> <p>Dedicated youth spaces have now been developed for both Kinglake and Flowerdale.</p> <p><u>Recommendation</u></p> <p>Delete action due to its completion.</p>
A5.16	Work with government and community service providers to develop an integrated strategy to enable older adults to 'age in place'	Medium-Long Term	The consultation and research process identified a trend for older adults to leave the study area as they age	Murrindindi Shire Council Department of Health	Identification for funding for and Ageing In Place Strategy	5.1, 5.2, 5.5	<p>No specific action undertaken by Council in study area.</p> <p>Council has developed a Positive Aging Action Plan which will address this issue from a shire-wide perspective.</p> <p><u>Recommendation</u></p>

							Reframe action to focus on implementation of Positive Aging Strategy as it pertains to the study area.
A5.17	Investigate the availability of the existing cemetery reserve in Kinglake West to be utilised for a cemetery or memorial reserve	Medium Term	There is no currently active cemetery reserve within the study area. Local community members have expressed support for a cemetery within the study area	Murrindindi Shire Council	To be determined	5.4	No action taken to date by Council. Existing Reserve is Crown Land under DEPI management. <u>Recommendation</u> Action to remain as is
A5.18	Review demand for aged care services in the Study Area		To determine if there has been an impact on demand for, and/or provision of aged care services to residents of the study area post the 2009 bushfires. To adjust services if required to support ageing in place	Department of Health Hume Region	Ageing In Place Strategy	5.1, 5.2, 5.5	No specific action undertaken by Council in study area. Council has developed a Positive Aging Action Plan which will address this issue from a shire-wide perspective. <u>Recommendation</u> Reframe action to focus on implementation of Positive Aging Strategy as it pertains to the study area.

Key Direction 6 - Support Resilience, Safety and Adaptability

The natural environment and landscape and the hinterland setting of the area provides both opportunities and challenges for people living there.

Residents should be equipped to live within this unique environment so they are fully aware and prepared for future extreme weather events.

Residents and visitors can contribute to the sustainability of the region if they are fully engaged in building self-reliance and local partnerships, while recognising and managing the inherent natural risks and challenges of isolation and separation.

Action	Timing	Rationale	Lead Agency	How will this be achieved	Implement s Strategies	Current Status/ Work Completed to date
A6.1 Adopt a local planning policy for bushfire management. (Consistent with Rec. No. 45 of the 2009 Victorian Bushfires Royal Commission)	Short Term	Greater guidance should be provided to landowners and decision makers, including local government planners, of the need to comprehensively consider and address fire risk when considering proposals for new land use and development.	Murrindindi Shire Council	Murrindindi Planning Scheme	5.1, 6.1, 6.2	Council has developed a draft Local Bushfire Planning Policy and prepared an amendment to incorporate the Policy into the Planning Scheme. The amendment is currently awaiting Ministerial approval.. <u>Recommendation.</u> Delete action upon confirmation of approval of amendment.
A6.2 Improve fire risk management through: Preparation of a Municipal Fire Management Plan Preparation of a Fire Risk Register for the study area Designation of Neighbourhood Safer Places Preparation of Township Protection Plans Improved fire risk mapping in the study area to better understand the risk profile Establishment of designated buffers and landscape strategies to reduce risk Improved management of fuel loads on public land and	Short Term	The 2009 Victorian Bushfires Royal Commission identified numerous actions to improve fire management. Many of these recommendations are of direct relevance to the study area and should be implemented in the short term.	Country Fire Authority Murrindindi Shire Council Department of Planning and Community Development Department of Sustainability and Environment Parks Victoria	Municipal Fire Management Plan Victorian Fire Risk Register Process Township Protection Planning Process Murrindindi Planning Scheme (fire risk mapping) Public Land Management Processes including the Kinglake National Park Management Plan	5.1, 6.1, 6.2	Council adopted the Municipal Fire Management Plan in December 2012 . To date NSP's have been designated for Flowerdale and Kinglake West. Township Protection Plans (now called Community Reference Guides by CFA) are in place for Toolangi, Kinglake , Kinglake West and Flowerdale. Council implements an annual program of inspection of private properties in the study area to assess and manage fuel loads prior to the fire season. Council is not the lead agency for fire risk mapping or establishing a fire risk register (CFA, DPCD, DSE) <u>Recommendation</u> Action to be revised to reflect the work completed to date

	private land, particularly in proximity to settlements						
A6.3	Remove the potential for further residential subdivision to occur within the rural residential estate in Castella	Short Term	The removal of subdivision potential in Castella will ensure that the intensity of development within an established rural residential estate will not increase.	Murrindindi Shire Council Department of Planning and Community Development.	Murrindindi Planning Scheme	6.1	This action cannot be implemented until the Study is finalised and adopted by Council and the necessary amendment of the Murrindindi Planning Scheme occurs. <u>Recommendation</u> Action to remain as is
A6.4	Undertake improved flood modelling along the King Parrot Creek in Hazeldene and Flowerdale to better understand flood risk and provide the basis for a management strategy	Immediate	There are many dwellings located along the narrow valley of the King Parrot Creek in Hazeldene and Flowerdale that may be at risk from flooding events.	Goulburn Broken Catchment Management Authority (study underway and due to be completed by Feb 2011)	Flood Management Study	5.1, 6.1, 6.2,	No specific action taken by Council GBCMA is the lead agency <u>Recommendation</u> Confirm status of action with GBCMA and revise if appropriate.
A6.5	Identify locations within the study area where existing development is subject to unacceptably high bushfire risk using latest fire risk profile mapping	Short Term	These areas could be nominated for consideration as part of any future retreat and resettlement strategy implemented by the Victorian Government	Country Fire Authority	Murrindindi Planning Scheme (these areas may need to be identified in the planning scheme)	6.1	Bushfire mapping work has been undertaken by DSE/DPCD as part of the development of the new Bushfire Management Overlay for the study area. Currently with DPCD and yet to be incorporated into the Planning Scheme. <u>Recommendation</u> Action to be deleted upon incorporation of the BMO into the Murrindindi Planning Scheme.

Key Direction 7 - Improve Connections

Building strong, reliable and safe connections within these peri-urban communities, across the region and to metropolitan Melbourne and beyond, will allow for greater choice in terms of employment, recreation, education and cultural activities. It also helps to reduce the isolation of small towns and farm living.

Better local physical connections expand opportunities for recreation and active lifestyles, and enhanced community safety and social interaction, while improved telecommunications are important in connecting home-based and local businesses, and in reducing the need to travel.

Action	Timing	Rationale	Lead Agency	How will this be achieved	Implements Strategies	Current Status/ Work Completed to date
<p>A7.1</p>	<p>Consolidating key services, information and activity around key nodes in each settlement as part of design frameworks and services planning</p>	<p>Short-Long Term</p>	<p>The consolidation of facilities delivers synergies and economies of scale that make service and information provision more viable and accessible to the community</p>	<p>Murrindindi Shire Council Department of Planning and Community Development. Department of Health</p>	<p>Recognise the Design Frameworks contained in this document in the Murrindindi Planning Scheme</p>	<p>1.3, 4.1, 4.3, 5.4, 7.3</p> <p>Not possible to reference or incorporate the study into the Murrindindi Planning Scheme until such time as the study is completed and officially adopted by Council.</p> <p><u>Recommendation</u> Action to remain as is.</p>
<p>A7.2</p>	<p>Construct off road pedestrian, cyclist and bridle trails within and between settlements and to natural attractions including the Kinglake National Park where there are missing links.</p>	<p>Short – Long Term</p>	<p>The ability of pedestrians, cyclists and horse riders to travel safely within the study area is limited by the lack of off road trails in some locations</p>	<p>Murrindindi Shire Council VicRoads</p>	<p>Allocating funding in Councils capital works budget</p>	<p>3.3, 3.5, 5.1, 5.4, 6.1, 7.1, 7.3.</p> <p>Council has been completed or progressed several recent projects in the study area including:</p> <p>Flowerdale – new working/cycling path connecting Flowerdale community with Spring Valley Rec Reserve</p> <p>Flowerdale – reconstructed walking/cycling path connecting school and residential areas (to Riverside Drive)</p> <p>Kinglake – new walking/cycle path connecting Kinglake to Kinglake Central and community facilities in Extons Rd</p> <p>Kinglake West – reconstructed and extended walking/cycling path between KW and Kinglake Central (effectively connecting KW to Kinglake)</p> <p>Kinglake History Art Walk – grant funding announced</p> <p>Kinglake to Mt Slide walking path – to commence construction 2012/2013</p> <p>Toolangi Tall Trees Trail – 7km multipurpose (walk/cycle/horse) trail constructed around Toolangi</p>

							<p><u>Recommendation</u></p> <p>Revise action taking into consideration works already completed / underway.</p>
A7.3	<p>Explore opportunities to improve all telecommunications (telephony, television, radio, wireless and broadband) access within the Shire of Murrindindi.</p> <p>Investigate the revised governing frameworks around the rollout of the National Broadband Network and develop a positioning strategy to prioritise rollout in the region</p>	Short – Medium Term	Improved telecommunications will provide greater local connectivity and information, better support networks, greater support for business, opportunities to work at home and reduce travel to work and improve safety during emergencies	Murrindindi Shire Council State Government	Lobby the National Broadband Network Co. and telecommunication s providers to provide improved infrastructure to the area	2.2, 2.5, 3.3, 5.3, 5.4, 6.1, 6.2, 7.2, 7.3.	<p>NBN Fibre rollout to commence in area of Kinglake to Kinglake West within 3 years.</p> <p>Council currently in discussion with NBN Co concerning the fixed wireless NBN roll out in the Shire, including other parts of the study area (Toolangi and Flowerdale)</p> <p><u>Recommendation</u></p> <p>Action to be revised on basis of current NBN rollout plans for the study area.</p>
A7.4	Develop and implement local information strategies which utilise a range of media, including community noticeboards (hard copy and electronic) access to on-line information and staffed information at Kinglake Town Centre.	Short – Long Term	Improved delivery of information will result in a more informed and engaged community	Murrindindi Shire Council	Council Communications Strategy	1.3, 5.1, 5.2, 5.4, 6.1, 6.2, 7.3.	<p>Council has installed community noticeboards in towns within the study area.</p> <p>Council has an existing communications strategy and protocols that includes the study area.</p> <p><u>Recommendation</u></p> <p>Action to be reframed to reflect need for implementation and continuous improvement of current strategy for the study area.</p>
A7.5	<p>Explore opportunities for improved and alternative public and community transport within the study area and improved connections to key local, regional and metropolitan destinations</p> <p>Work with local business and community service providers to promote the role and potential of existing community transport facilities to enhance local access (e.g. Regular community bus link to retail and community facilities)</p>	Short – Long term	Providing greater variety of transport options better linked to destinations will support social and economic well-being	Murrindindi Shire Council Department of Transport Hume Region	To be determined	1.3, 3.3, 5.1, 5.2, 5.3, 5.4, 7.1, 7.3.	<p>Public transport trials connecting the Kinglake Ranges to metropolitan centres are under trial by the Dept. of Transport .</p> <p>The Transport Connection Project has highlighted a number of these issues and work is currently being focused on:</p> <ul style="list-style-type: none"> - Improving access to health services - Local innovations projects including Youth Commute and Community Connect with the aim of utilising existing transport infrastructure to resolve issues of access for young people and older adults. <p><u>Recommendation</u></p> <p>Action to be revised to reflect action completed to date.</p>

The Kinglake Ranges, Flowerdale and Toolangi Draft Plan and Design Framework Tables

Current status of Implementation Strategy Actions excluding
Direction 1 Actions which refer to Settlement Planning and Growth
June 2013

Key Direction 2 - Ensure a Viable Local Economy

The Kinglake Ranges, Flowerdale and Toolangi region needs to provide sufficient levels of employment, services and business opportunities to support the livelihood and wellbeing of local communities, recognising that as part of Melbourne's hinterland, these communities also benefit from close proximity to employment and services in the metropolitan area.

Local economic development should harness, protect and enhance those factors that give the region its competitive advantage including fertile soils and farming land, tranquil rural townships, natural beauty, environmental values, and self-reliant and creative people.

A more sustainable future will embrace opportunities in the new green economy based around greater self-sufficiency, new agri-business and tourism that draw on the natural assets of the region including the Kinglake National Park and highly productive agricultural land.

Action		Timing	Rationale	Lead Agency	How will this be achieved	Implements Strategies	Current Status/ Work Completed to Date
A2.1	<p>Establish a brand identity for the study area which captures the strengths and advantages of the region such as the natural and recreational values of the area - (e.g. "Melbourne's playground of the north".)</p> <p>The brand identity must be consistent with the core values held by the community</p>	Medium Term	<p>A brand identity can contribute to economic development through promoting tourism visitation and the sale of local produce</p> <p>The Kinglake National Park will continue to generate the highest visitation</p>	<p>Murrindindi Shire Council</p> <p>Tourism Victoria</p> <p>Kinglake Ranges Tourism and Business Association</p> <p>Goulburn River Valley Tourism</p> <p>Parks Victoria</p>	Council's Economic Development Strategy	1.2, 2.1, 2.2, 2.3, 2.4, 2.5, 3.4.	<p>No action taken by Council to date.</p> <p>Need to consider the cost and implications of creating and promoting a unique brand for the study area, given work undertaken to date to promote the broader attractions of "Murrindindi" as a region.</p> <p>Focus could be on area specific marketing/promotional features within context of overall regional marketing initiatives</p> <p><u>Recommendation</u></p> <p>Re-frame action to create feature marketing initiatives within existing mediums (OVG, GRVT etc)</p>
A2.2	<p>Support improved infrastructure, including high speed internet to support small, creative and innovative businesses</p>	Medium Term	<p>Small, creative and innovative businesses are consistent with the core values expressed by residents and will provide opportunities for local residents to stay on the mountain.</p>	<p>Murrindindi Shire Council</p> <p>Federal Government</p>	Lobby the National Broadband Network Co. and telecommunications providers to provide improved infrastructure to the area	2.2, 2.5, 5.3, 7.2	<p>Council has made representation to the Federal Government to seek improved outcomes for Murrindindi, including the study area, with respect to the provision of telecommunications/broadband services.</p> <p>NBN Fibre rollout to commence in area of Kinglake to Kinglake West within 3 years. Fixed wireless roll out in areas adjoining Kinglake is also scheduled in next three years.</p> <p><u>Recommendation</u></p> <p>Action to remain with a shire-wide focus, not specific to KR</p>

<p>A2.3</p>	<p>Improve the tourist offer through:</p> <ul style="list-style-type: none"> • Linking settlements directly, or by way of information, with improved tourist facilities in the Kinglake National Park promoting towns as gateways to the National Park (for example, Visitor Interpretative Centre, Visitor Information Boards in settlement nodes, viewing platform at Mt Sugarloaf, downhill Mountain bike course, improved walking trails) • Improved road cyclist infrastructure including mileage markers and signage on mountain climbs approaching study area (Humevale Road and Heidelberg – Kinglake Road) • Establish tourist walking/cycling and driving routes that guide visitors to local attractions • Improved park visitor facilities (improved picnic area at masons falls) 	<p>Short Term</p>	<p>Existing links between settlements and the natural assets of the region are fragmented and uncoordinated.</p> <p>Alignment of key settlement linkages with natural assets will provide for better integration and synergies for settlements and local communities.</p>	<p>Murrindindi Shire Council</p> <p>Whittlesea and Nillumbik Councils (cyclist infrastructure)</p> <p>VicRoads</p> <p>Tourism Victoria</p> <p>Parks Victoria for Kinglake National Park facilities</p>	<p>Kinglake National Park Masterplan</p> <p>Council capital works budgets (signage)</p>	<p>2.1, 2.4, 3.5, 5.1, 5.4, 7.1, 7.3</p>	<p>Council has supported the Kinglake Ranges Business Network with financial input and content advice and editing in relation to one refurbished and six new visitor information boards across the Kinglake Ranges.</p> <p>Through 2012 Parks Victoria has progressed restoration and improvement works at a number of sites identified as priorities in the Kinglake National Park Masterplan, including:</p> <ul style="list-style-type: none"> • Masons Falls. • Jehosaphat Gully. • Bowden Spur Mountain Bike Trail. <p>Additional works identified in the Masterplan will be progressed by Parks Victoria as funding becomes available.</p> <p><u>Recommendation</u></p> <p>Action to remain as ongoing action to improve tourism offerings through appropriate infrastructure as resources become available</p>
<p>A2.4</p>	<p>Support the re-establishment of a petrol station in Kinglake</p>	<p>Short Term</p>	<p>Residents have no choice but to travel off the mountain to purchase fuel. This contributes to the leakage of retail expenditure. A permanent petrol station in the study area would help to limit trade leakage</p>	<p>Murrindindi Shire Council</p>	<p>To be determined</p>	<p>4.3</p>	<p>Temporary fuel station has been in operation in Kinglake for two years on land leased by Council and with support of the FRU.</p> <p>Council has continued to facilitate opportunities for the re-establishment of permanent facilities and is currently in discussion with a potential developer/operator.</p> <p><u>Recommendation</u></p> <p>Action likely to be achieved with current development proposal – delete from strategy upon confirmation of planning and building approvals</p>

A2.5	Undertake a detailed study to determine the rate of breakdown of Dieldrin in soils within the study area in order to better understand longer term production issues including for organic farming	Short Term	<p>The presence of Dieldrin in soils places limitations on what it can be used for (growing of certain crops, grazing of livestock) and for certification of organic farming</p> <p>There is limited knowledge as to how long it will be before Dieldrin concentrations in the study area are naturally reduced to the point where limitations on land use will be reduced / totally removed</p>	Department of Primary Industries	Detailed environmental study	1.2, 2.2, 2.3.	<p>No action taken by Council to date.</p> <p>DEPI is the lead agency</p> <p><u>Recommendation</u></p> <p>Seek advice from DEPI if this is likely to be undertaken. If not, delete from strategy.</p>
A2.6	Include the study area in relevant agribusiness development programs run by DPI	Short Term	The high quality soils and high rainfall of much of the study area presents opportunities for agribusiness to establish in the study area	Department of Primary Industries	Agfutures Program	1.2, 2.2, 2.3.	<p>No action taken by Council to date</p> <p>DEPI is the lead agency</p> <p><u>Recommendation</u></p> <p>Seek advice from DEPI if this is likely to be undertaken. If not delete from strategy.</p>
A2.7	Explore opportunities for agriculture related tourism such as farmgate sales and farmers market	Short - Medium Term	The highly productive agricultural land within the study area and the proximity to Melbourne provide opportunities for agriculture related tourism	Murrindindi Shire Council Tourism Victoria	Council's Economic Development Strategy	2.2,2.3	<p>No specific action taken by Council in the study area, however Council has made comment/submission to the Minister for Planning in relation to the potential revisions to the farming zone to provide opportunities for tourism/agriculture uses.</p> <p>The Kinglake Framers Market has been established, with funding support provided by RDV.</p> <p><u>Recommendation</u></p> <p>Action partly completed, reframe action on promotion of opportunities subject to outcomes of the Farming Zones review.</p>
A2.8	Review the appropriateness of the Farming Zone provisions as they apply to small lots within the study area located outside of recognized settlements (following Government review of planning	Short - Medium Term	The application of the Farming Zone to small lots within the study area that are located outside of recognized settlements is problematic as many of these lots are too small to	Department of Planning and Community Development	Murrindindi Planning Scheme	1.4, 2.2	<p>The Council is awaiting the outcome of the Ministerial review of planning zones.</p> <p>DPCD is the lead agency</p> <p><u>Recommendation</u></p>

	zones)		be used for productive agriculture The Farming Zone does not reflect the use of these lots and places limitations on their use and development				Action remains, subject to review of Farming Zones by the State
--	--------	--	---	--	--	--	---

Key Direction 3 - Protect and Enhance the Environment

The Kinglake Ranges, Flowerdale and Toolangi region features highly valued natural landscapes and areas of environmental significance that must be protected and restored. These features directly and indirectly influence all activity in the region and are its strongest asset. This is reflected in the high level of community awareness about the importance of the local environment.

The natural landscape attracts residents and visitors alike and distinguishes this region from any other, but it is facing significant challenges. The ecological restoration process following the bushfires is underway but will take many years.

External pressures such as climate change and urban and agricultural land uses present critical challenges to the environmental values of the area. There is a need to focus on improving the resilience of the environment to face these challenges while allowing for the necessary interaction between the community and the environment.

Action		Timing	Rationale	Lead Agency	How will this be achieved	Implements Strategies	Current Status/ Work Completed to Date
A3.1	<p>Re-cast the townships as gateways to the natural assets of the area through improved signage and way finding</p> <p>Undertake a retail development strategy specifically for the study area to realise the potential for eco-tourism related expenditure</p>	Medium Term	<p>The settlements of the Kinglake Ranges should be re-cast as gateways to the natural assets of the area.</p> <p>The high numbers forecast for future visitation of the Kinglake National Park present an opportunity to provide tourists with a logical pathway to stop in the townships and for local business to earn revenue from retail activities.</p>	<p>Murrindindi Shire Council</p> <p>Parks Victoria</p> <p>Tourism Victoria</p>	<p>Prepare a wayfinding strategy to improve signage and way finding.</p> <p>Implement the recommendations of the Design Frameworks through Councils capital works program.</p>	2.1, 2.5, 7.1.	<p>New Shire and Town Entry signage has been installed by Council in the study area following the loss of signage during the fires.</p> <p>Council in discussion with potential developer of retail premises in Kinglake township.</p> <p>No other action taken to date.</p> <p><u>Recommendation</u></p> <p>Action requires partnership with Parks Victoria. Action to remain as is.</p>
A3.2	<p>Monitor outcomes from the Yarra Valley Water Kinglake West demonstration project and apply relevant learnings elsewhere in the study area</p>	Medium - Long Term	<p>The environmental impacts of effluent entering waterways are significant and need to be addressed particularly in locations such as Flowerdale and</p>	<p>Murrindindi Shire Council</p> <p>Department of Planning and Community Development</p>	<p>Murrindindi Planning Scheme (for new development proposals that generate waste water).</p> <p>Council's role in</p>	3.2, 3.4.	<p>It will be some time before proper evaluation can be undertaken to assess the effectiveness of the project and to apply these learnings elsewhere.</p> <p>It is unlikely that this sewerage treatment system will be replicated in areas such as Kinglake township, Flowerdale or Hazeldene in the near future unless</p>

			Hazeldene with houses in close proximity to the King Parrot Creek.	Department of Sustainability and Environment Environment Protection Authority	Environmental Health management.		funded by government. Although Council made representation on this issue, the opportunity to pursue innovative approaches to waste water management in the study area was not pursued by Government as part of the bushfire rebuilding program. <u>Recommendation</u> Lead agency unclear. Unlikely to be able to apply learning elsewhere in study area due to cost of infrastructure required. Action needs to be reframed to reflect an advocacy approach.
A3.3	Undertake technical assessments of the wastewater treatment system installed as part of the Kinglake temporary village to ascertain its level of performance and ability to support development in the long term	Short Term	The waste water system is a significant government investment and may provide an opportunity for retrofit commercial centre.	Murrindindi Shire Council Environment Protection Authority	Council in conjunction with the EPA undertake the assessment.		Decision was made by Department of Human Services to decommission the system as part of the decommissioning of the temporary village. Major components of the effluent disposal infrastructure remain in-situ at the Village site . It is unclear if the site will be supported by the government (Minister for Planning) for future development. It is also unknown whether the existing infrastructure located at the village may provide a future servicing option for the existing Kinglake Township and its potential expansion <u>Recommendation</u> Subject to advice from the State Government with respect to development likelihood.
A3.4	Work with the EPA to evaluate improved onsite wastewater disposal solutions that are affordable and reduce environmental and health risks	Medium - Long Term	Outdated and poorly maintained onsite waste water systems are leading to environmental degradation and potential health risks in a number of settlement locations.	Murrindindi Shire Council Environment Protection Authority	Council to continue engagement with the EPA		Council has worked with landowners as part of the rebuilding program to encourage septic tank system upgrades, which has resulted in improved wastewater management outcomes in the study area. There has been no specific action taken in relation to septic tank upgrades on existing dwellings in study area. <u>Recommendation</u> Refer action to Council's Waste Water Strategy. Not specific to Kinglake Ranges
A3.5	Promote further education within the community on the environmental impacts and health risks associated	Long Term	Better maintenance of individual on site waste water systems is a land holder	Murrindindi Shire Council	Council communication with residents		Council has increased its resources to improve monitoring of septic systems in the Shire

	with run-off from septic tanks entering waterways and groundwater		responsibility.				<u>Recommendation</u> Refer action to Council's Waste Water Strategy. Not specific to Kinglake Ranges.
A3.6	Pursue funding for a reticulated waste water treatment system for Hazeldene and Flowerdale and other settlements within the study area	Medium – Long Term	The environmental and health benefits from retrofitting existing settlements with wastewater treatment systems are significant. Hazeldene and Flowerdale have been identified as the highest priorities for a reticulated system given lot sizes and proximity to the King Parrot Creek.	Murrindindi Shire Council	Engagement with relevant water authorities	3.1, 3.2	No specific action taken by Council to date It is unlikely that a reticulated waste water treatment system will be implemented in areas such as Kinglake township, Flowerdale or Hazeldene in the medium term (if at all) due to prohibitive infrastructure costs. Despite Council representation on this issue, the opportunity to pursue this approach was not pursued by the Government as part of the bushfire rebuilding program. Council has worked with landowners as part of the rebuilding program to encourage septic tank system upgrades, which has resulted in improved wastewater management outcomes in the study area. <u>Recommendation</u> Funding unlikely due to the cost involved. Reframe action to an advocacy role or delete.
A3.7	Establish biolinks (habitat corridors) between forested land	Medium-Long Term	Provide safe and protected habitat corridors will maximise the movement and migration of fauna and the viability of flora	Murrindindi Shire Council Department of Sustainability and Environment Parks Victoria	To be determined	3.1	No action taken to date By Council. Council unlikely to be a lead agency in this issue. <u>Recommendation</u> Confirm alignment with DEPI principles / strategies, if no alignment or specific action likely, delete.
A3.8	Undertake detailed modelling of the Kinglake Groundwater Management Area to better understand the aquifer and quantity of water that can be extracted sustainably and inform the development of a Groundwater Management Strategy Communicate to the community the facts	Short Term	Groundwater is an important resource to farmers and residents within the study area. A better understanding of the aquifer and a consequent management strategy will ensure that its long term sustainability is	Goulburn Murray Water	Groundwater Management Strategy for the Kinglake Groundwater Management Area	3.1, 3.2	GMW is in the process of reviewing its Ground Water Management Plan for the study area (particularly Kinglake). Water licensing for commercial/irrigation ground and surface water will remain capped in study area. GMW is lead agency <u>Recommendation</u> Action being implemented by GMW. Suggest reframe action to provide ongoing community

	regarding sustainable groundwater use in the region		ensured.				information/education on the matter.
--	---	--	----------	--	--	--	--------------------------------------

Key Direction 4 - Create Attractive, Distinctive and Vibrant Towns

Local towns provide the services and businesses that meet the daily needs of local communities and support rural lifestyles. Having evolved with different histories and for different reasons, linked to farming, forests or the Kinglake National Park, each town in the study area contributes strongly to a sense of place and community identity for local residents. In recent years, they have also offered lifestyle and affordable housing choices close to Melbourne. However, in some instances, the decline of farming, along with fragmented patterns of development, has detracted from the attractiveness, function and viability of these townships.

Attributes that should be strengthened through the Plan and Design Framework include:

- local township identity and sense of place
- distinctive cultural heritage
- unique natural settings
- the right mix of businesses and services that support viable towns and local settlements.

Action		Timing	Rationale	Lead Agency	How will this be achieved	Implements Strategies	Current Status/ Work Completed to Date
A4.1	Remove the inconsistencies between locality boundaries recognised by existing signage, Government agencies (i.e. Australia Post) and local residents understanding of locality boundaries	Short Term	The identity issue has been raised by many residents. This issue is widespread in many areas such as Kinglake West/Pheasant Creek, Hazeldene and Flowerdale and Toolangi and Castella.	Murrindindi Shire Council Department of Planning and Community Development	Through the process outlined in the Guidelines for Geographic Names 2010	4.4	A preliminary review to confirm current official boundaries between Kinglake West / Pheasant Creek and Castella / Toolangi has been undertaken by Council. <u>Recommendation</u> Action to remain
A4.2	Implement design frameworks prepared as part of this study to improve the attractiveness and functionality of settlements within the study area. This should also include protection of significant views, vistas and the establishment of landscape buffers	Short – Long Term	Improving the attractiveness of settlements via the creation of logical nodes and meeting places will benefit both residents and the overall viability of settlements.	Murrindindi Shire Council	Recognise the Design Frameworks contained in this document in the Murrindindi Planning Scheme.	1.1, 1.3, 4.1, 4.2, 4.3, 4.4, 5.1.	No action taken by Council to date. Further work is needed to develop the design frameworks prior to implementation. This specific piece of work can be progressed subject to DPCD and Council agreement on funding, expected outcomes and timelines. <u>Recommendation</u> Action to remain

A4.3	Develop and implement design guidelines to ensure that new development within the study area does not compete or detract from its natural landscape setting	Short – Long Term	The unique landscape setting of the study area should not be impacted upon by new development. It is generally accepted that built form contributes to (or can detract from) the character and identity of a place.	Murrindindi Shire Council	Recognise the Design Frameworks contained in this document in the Murrindindi Planning Scheme.	1.1, 4.2.	Not possible to reference or incorporate the study into the Murrindindi Planning Scheme until such time as the study is completed and officially adopted by Council. Comment as per A4.2 <u>Recommendation</u> Action to remain
A4.4	Improve identity through a comprehensive Way Finding strategy which includes urban design elements such as community nodes, civic hubs, pathways, gateways and entry features and varied public open spaces	Short Term	The legibility of individual settlements and the presentation and identity of the region as a whole will benefit from a coordinated approach to linkages, presentation and information.	Murrindindi Shire Council	Prepare a wayfinding strategy to improve signage and way finding.	2.1, 2.5, 7.1.	Action similar to A3.1 No action taken by Council to date on developing a Wayfinding Strategy. Comment as per A4.2 <u>Recommendation</u> Action to remain

Key Direction 5 - Support the Wellbeing of Local Communities

Wellbeing is influenced by the social, economic and physical environments in which we live and the way we interact with those living conditions. Wellbeing is not just about being healthy or sick, but about the quality of our lives and our communities.

This Plan seeks to support and enhance:

- the services, facilities and amenity of each township that will enable community wellbeing to flourish
- the capacity of groups and individuals to initiate community activities and participate in community life
- the resilience, safety and sense of belonging of all residents.

Action		Timing	Rationale	Lead Agency	How will this be achieved	Implements Strategies	Current Status/ Work Completed to date
A5.1	<p>Ensure access to well-located base-line community infrastructure in each settlement, including; community meeting space, local open space and play facilities and community information (including access to information technology)</p> <p>Community infrastructure should be co-located (e.g. Clustering of community facilities) and adjacent to public transport where available</p>	Medium Term	<p>All communities should have access to flexible community infrastructure which supports the needs of all ages and can respond to changing needs over time. Emphasis should be placed on the capacity and sustainability of walkable local facilities.</p>	Murrindindi Shire Council	<p>Working with local service providers and residents in each settlement to respond to the findings of the Community Wellbeing Issues Paper.</p> <p>Adopting locational criteria for the provision of any future facilities.</p>	5.1 5.2 5.3	<p>Through the Bushfire Recovery response a significant amount of new or enhanced community infrastructure has been built (or is near completion) across the study area pertaining to health/medical services, recreational, youth space, open / play space and multi –use meeting space needs.</p> <p>Co-location has been sought where-ever possible to create hubs of activity (eg. Kinglake municipal offices and library with medical centre and play space. Kinglake Central new school, early learning centre, play space , senior citizens and recreation reserve. Flowerdale school, early learning Centre, youth facility, community meeting space etc).</p> <p><u>Recommendation:</u></p> <p>Action to remain as a principle guiding future provision of community infrastructure.</p>
A5.2	<p>Develop local open space and play opportunities in each settlement catering for a range of ages and interests, supporting the role of local open space for community gathering and informal recreation</p>	Medium – Long Term	<p>Supporting the role local open space plays in providing opportunities for physical activity and social interaction</p> <p>Local open space and play opportunities should be developed for settlements that lack these, particularly</p>	Murrindindi Shire Council	Preparation and implementation of Open Space Strategy.	5.1 5.2 5.3 5.4	<p>Several open space projects have recently been completed in the Study Area including Castella Park, Bollygum Adventure Park, Kinglake Memorial Reserve re-development, Kinglake Lions Park re-development, Kinglake West Reserve Reflective gardens, Flowerdale Community House playspace, Moores Rd playspace Flowerdale, Spring Valley Recreation Reserve sporting and facility enhancements.</p>

			at Flowerdale/Hazeldene and Kinglake				Unlikely to be further development of facilities in the short to medium term. <u>Recommendation</u> Action to remain as a principle guiding future provision of community infrastructure.
A5.3	Identify opportunities to improve walking and cycling access within townships, as well as links to Kinglake National Park and State Forest	Medium – Long Term	Strong interest in supporting physical connections between towns and optimising the health benefits of physical activity	Murrindindi Shire Council	Preparation and implementation of Active Transport Strategy	5.1	No specific strategy work has been undertaken by Council, although several pathways have recently been constructed (see A7.2) Parks Victoria is also a key agency. <u>Recommendation</u> Action to remain.
A5.4	Continue to explore opportunities with the Department of Education and Early Childhood Development (DEECD) to identify a sustainable model for post-Primary education to be provided in the study area (e.g. Primary to year 9)	Medium – LongTerm	The research and consultation process identified the potential role of secondary education in supporting young people to maintain their social connections and support networks in the local area and to reduce long daily commutes for children	Murrindindi Shire Council Department of Education and Early Childhood Development	Formation of "Post-Primary Education Options" Working Group.	5.1 5.2 5.5	No recent action taken by Council. DEECD has advised that there are no specific short to medium term plans to provide post-primary education in the Study area. Currently there is concern of impacts on existing secondary schools in the region <u>Recommendation</u> Action to remain but highlighting the longer term nature of the issue.
A5.6	Permanent consulting rooms should be constructed in the Kinglake Ranges to enable provision of GP services and other complimentary health and allied health services Rural Workforce Agency of Victoria to assist with the procurement of permanent general practice services to operate from the consulting rooms at the level determined by assessment of community need	Short Term	The study area needs to build its capacity to respond to models of health service delivery which are based on the flexible delivery of services where they are most needed and to support service coordination and cross-referral. The current administrative reference north to the Hume region is at odds with the natural service usage patterns of this peri-urban community back towards Melbourne	Federal Government Department of Health Rural workforce Agency of Victoria	Pending	5.2, 5.5	Permanent medical facilities (GP Consulting rooms) have now been constructed in Kinglake on Council land adjacent to the Council offices. Mitchell Community Health operate the medical facilities and provide GP services. <u>Recommendation</u> Delete action due to its completion.

A5.7	Prepare an Arts and Cultural strategy to identify ways in which arts and cultural activities contribute to the economic and social wellbeing of local communities and to guide investment in the development of arts and cultural facilities	Short Term	Arts and culture enriches the local communities and strengthens social fabric	Murrindindi Shire Council	Development and implementation of an Arts and Cultural Strategy	5.4	<p>Council has recently developed an Arts and Culture policy for the municipality which describes Council's roles as a supporter and facilitator of arts and culture initiatives, but not a driver or provider of such.</p> <p><u>Recommendation</u></p> <p>Reframe action to support community initiatives aimed at developing arts and cultural opportunities.</p>
A5.8	Work with local primary schools to enhance community use of facilities out of school hours	Immediate	There has been considerable investment in infrastructure for primary education, this project has identified the opportunity to optimise the value from this investment by ensure the facilities with primary school are made available to the wider community	Murrindindi Shire Council Department of Education and Early Childhood Development	MOU between Council and primary schools	5.1, 5.2, 5.5	<p>No specific action taken by Council to date, other than the formation of joint use agreements where Council has a financial interest in the facilities (Marysville, Kinglake Central and Flowerdale).</p> <p>DEECD would need to be the driver.</p> <p><u>Recommendation:</u></p> <p>Confirm current position/direction of DEECD on this issue and revise action or delete as appropriate.</p>
A5.9	Work with training providers to offer targeted vocational training to support employment pathways for young people (e.g. Hospitality training) and those returning to work.	Medium - Long Term	The project has identified demand for vocational training from local businesses and individuals to improve employment skills and capacity	Education & training providers. Murrindindi Shire Council	Identify funding for a training needs assessment to be undertaken in association with local employers	5.2, 5.5	<p>Council has recently worked with the Local Learning and Employment Network in the conduct of a Training Demand Study across the municipality, including the Study Area. The outcomes identify current skill and training gaps and opportunities to address the gaps.</p> <p><u>Recommendation</u></p> <p>Reframe action to focus on implementation of actions of the recent study that are relevant to the study area.</p>
A5.10	Provide on-going support and training for community volunteers	Medium - Long Term	The nature of community activity and community service provision in the study area requires on-going support to the volunteers who provide these activities	Murrindindi Shire Council Department of Planning and Community Development Community organisations	5.2, 5.3	<p>Council continues to provide ongoing support and training to volunteers assisting within Council run programs in the area.</p> <p>Other key organisations utilising volunteers in the study area include Berry Street and Catholic Care, these organisations have Volunteer Coordination resources to assist in the provision of training and ongoing support.</p> <p>DHS is currently developing a model whereby three or four agencies will provide a qualified</p>	

							<p>clinician on a rostered basis to provide support to community leaders who themselves are relied upon by 'in need' community members.</p> <p><u>Recommendation</u></p> <p>Action remains as is</p>
A5.11	<p>Identify opportunities to increase whole-of-life participation in recreation opportunities (e.g. Age-appropriate programming of recreation facilities)</p>	Immediate	<p>There has been considerable investment in recreational infrastructure, this project has identified the opportunity to optimise the value from this investment by ensuring recreation facilities are welcoming and appropriate to all ages and interests</p>	<p>Murrindindi Shire Council</p> <p>Community Organisations</p>	<p>Audit of current usage of recreation facilities</p>	5.2, 5.5	<p>No specific action undertaken recently in the study area.</p> <p>In the 2013/2014 year the Council will be reviewing its recreation strategy and it is envisaged whole-of-life participation in recreation will be a significant theme.</p> <p><u>Recommendation</u></p> <p>Action remains as is</p>
A5.12	<p>Identify opportunities for regular information exchange between council, service providers and local residents (e.g. On-line forums, regular community meetings)</p>	Medium Term	<p>Service provision is dispersed across the study area, with fragmented access to information</p>	<p>Murrindindi Shire Council</p> <p>Community Service Providers</p>	<p>Audit of existing information strategies</p>	5.3	<p>A Council representative currently attends the Kinglake Ranges Service Collaborative Meetings.</p> <p>These meetings provide a platform for information sharing and action amongst funded community service organisations providing both bushfire specific services and ongoing generic services. Membership to the Kinglake Ranges Community and Services Collaborative includes 21 Community Service Organisations, Local, State and Federal Government department representatives and local community members. The Department of Human Services has funded a project officer to assist in the development of a plan for the group as well as funding for venue and catering for monthly meetings until December 2012.</p> <p>Many of the agencies involved in the Kinglake Collaborative are partners of the local Primary Care Partnerships (PCPs). PCPs are funded to improve access to services and continuity of care for people through improved service coordination, as well as chronic disease prevention, integrated health promotion, and partnership development. The majority of service providers in the Kinglake, Flowerdale and Toolangi area are also members of the Murrindindi Community Services Network. These meetings and membership lists provide a good framework for distribution of information.</p>

							<p><u>Recommendation</u></p> <p>Action to remains as is</p>
A5.13	Investigate opportunities for the development of community enterprises which support local economic and employment opportunities (e.g. Food co-op, coordinated marketing of local businesses, cultural initiatives, community events)	Medium-Long	During the course of this study there has been considerable interest in developing community enterprise opportunities which build on local strengths, increase local economic activity and generate local jobs	Murrindindi Shire Council Department of Planning and Community Development	Identification of funding for a community enterprise strategy	5.5	<p>Council officers are currently working with the North East Community Initiatives Ltd, based in Kinglake, on the development of a social enterprise around recycling and waste management and aimed at providing employment opportunities for unemployed youth.</p> <p><u>Recommendation</u></p> <p>Action to remain as is</p>
A5.14	Work with young people to provide on-going support for information access and social opportunities	Short Term	Social and recreational opportunities for young people have been identified as a priority during this project	Murrindindi Shire Council Department of Planning and Community Development	On-going consultation with young people	5.1, 5.2, 5.5	<p>The Murrindindi Youth Strategy is aimed at the needs of young people across the Shire. The Youth Partnership Group have provided funding to resource Youth workers in the Kinglake Ranges area and the Coordinator Youth Development is working closely with Allimata Youth Group to assist in the development of a sustainable and successful youth space in Kinglake.</p> <p><u>Recommendation</u></p> <p>Action to remain as is</p>
A5.15	Identify an accessible location (co-located with other support services and transport) as a focus for young people in the study area	Short Term	Social and recreational opportunities for young people have been identified as a priority during this project	Murrindindi Shire Council Department of Planning and Community Development	Audit of the capacity & suitability of existing infrastructure to accommodate the needs of young people	5.1, 5.2, 5.5	<p>As per A5.14</p> <p>Dedicated youth spaces have now been developed for both Kinglake and Flowerdale.</p> <p><u>Recommendation</u></p> <p>Delete action due to its completion.</p>
A5.16	Work with government and community service providers to develop an integrated strategy to enable older adults to 'age in place'	Medium-Long Term	The consultation and research process identified a trend for older adults to leave the study area as they age	Murrindindi Shire Council Department of Health	Identification for funding for and Ageing In Place Strategy	5.1, 5.2, 5.5	<p>No specific action undertaken by Council in study area.</p> <p>Council has developed a Positive Aging Action Plan which will address this issue from a shire-wide perspective.</p> <p><u>Recommendation</u></p>

							Reframe action to focus on implementation of Positive Aging Strategy as it pertains to the study area.
A5.17	Investigate the availability of the existing cemetery reserve in Kinglake West to be utilised for a cemetery or memorial reserve	Medium Term	There is no currently active cemetery reserve within the study area. Local community members have expressed support for a cemetery within the study area	Murrindindi Shire Council	To be determined	5.4	No action taken to date by Council. Existing Reserve is Crown Land under DEPI management. <u>Recommendation</u> Action to remain as is
A5.18	Review demand for aged care services in the Study Area		To determine if there has been an impact on demand for, and/or provision of aged care services to residents of the study area post the 2009 bushfires. To adjust services if required to support ageing in place	Department of Health Hume Region	Ageing In Place Strategy	5.1, 5.2, 5.5	No specific action undertaken by Council in study area. Council has developed a Positive Aging Action Plan which will address this issue from a shire-wide perspective. <u>Recommendation</u> Reframe action to focus on implementation of Positive Aging Strategy as it pertains to the study area.

Key Direction 6 - Support Resilience, Safety and Adaptability

The natural environment and landscape and the hinterland setting of the area provides both opportunities and challenges for people living there.

Residents should be equipped to live within this unique environment so they are fully aware and prepared for future extreme weather events.

Residents and visitors can contribute to the sustainability of the region if they are fully engaged in building self-reliance and local partnerships, while recognising and managing the inherent natural risks and challenges of isolation and separation.

Action	Timing	Rationale	Lead Agency	How will this be achieved	Implement s Strategies	Current Status/ Work Completed to date
A6.1 Adopt a local planning policy for bushfire management. (Consistent with Rec. No. 45 of the 2009 Victorian Bushfires Royal Commission)	Short Term	Greater guidance should be provided to landowners and decision makers, including local government planners, of the need to comprehensively consider and address fire risk when considering proposals for new land use and development.	Murrindindi Shire Council	Murrindindi Planning Scheme	5.1, 6.1, 6.2	Council has developed a draft Local Bushfire Planning Policy and prepared an amendment to incorporate the Policy into the Planning Scheme. The amendment is currently awaiting Ministerial approval.. <u>Recommendation.</u> Delete action upon confirmation of approval of amendment.
A6.2 Improve fire risk management through: Preparation of a Municipal Fire Management Plan Preparation of a Fire Risk Register for the study area Designation of Neighbourhood Safer Places Preparation of Township Protection Plans Improved fire risk mapping in the study area to better understand the risk profile Establishment of designated buffers and landscape strategies to reduce risk Improved management of fuel loads on public land and	Short Term	The 2009 Victorian Bushfires Royal Commission identified numerous actions to improve fire management. Many of these recommendations are of direct relevance to the study area and should be implemented in the short term.	Country Fire Authority Murrindindi Shire Council Department of Planning and Community Development Department of Sustainability and Environment Parks Victoria	Municipal Fire Management Plan Victorian Fire Risk Register Process Township Protection Planning Process Murrindindi Planning Scheme (fire risk mapping) Public Land Management Processes including the Kinglake National Park Management Plan	5.1, 6.1, 6.2	Council adopted the Municipal Fire Management Plan in December 2012 . To date NSP's have been designated for Flowerdale and Kinglake West. Township Protection Plans (now called Community Reference Guides by CFA) are in place for Toolangi, Kinglake , Kinglake West and Flowerdale. Council implements an annual program of inspection of private properties in the study area to assess and manage fuel loads prior to the fire season. Council is not the lead agency for fire risk mapping or establishing a fire risk register (CFA, DPCD, DSE) <u>Recommendation</u> Action to be revised to reflect the work completed to date

	private land, particularly in proximity to settlements						
A6.3	Remove the potential for further residential subdivision to occur within the rural residential estate in Castella	Short Term	The removal of subdivision potential in Castella will ensure that the intensity of development within an established rural residential estate will not increase.	Murrindindi Shire Council Department of Planning and Community Development.	Murrindindi Planning Scheme	6.1	This action cannot be implemented until the Study is finalised and adopted by Council and the necessary amendment of the Murrindindi Planning Scheme occurs. <u>Recommendation</u> Action to remain as is
A6.4	Undertake improved flood modelling along the King Parrot Creek in Hazeldene and Flowerdale to better understand flood risk and provide the basis for a management strategy	Immediate	There are many dwellings located along the narrow valley of the King Parrot Creek in Hazeldene and Flowerdale that may be at risk from flooding events.	Goulburn Broken Catchment Management Authority (study underway and due to be completed by Feb 2011)	Flood Management Study	5.1, 6.1, 6.2,	No specific action taken by Council GBCMA is the lead agency <u>Recommendation</u> Confirm status of action with GBCMA and revise if appropriate.
A6.5	Identify locations within the study area where existing development is subject to unacceptably high bushfire risk using latest fire risk profile mapping	Short Term	These areas could be nominated for consideration as part of any future retreat and resettlement strategy implemented by the Victorian Government	Country Fire Authority	Murrindindi Planning Scheme (these areas may need to be identified in the planning scheme)	6.1	Bushfire mapping work has been undertaken by DSE/DPCD as part of the development of the new Bushfire Management Overlay for the study area. Currently with DPCD and yet to be incorporated into the Planning Scheme. <u>Recommendation</u> Action to be deleted upon incorporation of the BMO into the Murrindindi Planning Scheme.

Key Direction 7 - Improve Connections

Building strong, reliable and safe connections within these peri-urban communities, across the region and to metropolitan Melbourne and beyond, will allow for greater choice in terms of employment, recreation, education and cultural activities. It also helps to reduce the isolation of small towns and farm living.

Better local physical connections expand opportunities for recreation and active lifestyles, and enhanced community safety and social interaction, while improved telecommunications are important in connecting home-based and local businesses, and in reducing the need to travel.

Action	Timing	Rationale	Lead Agency	How will this be achieved	Implements Strategies	Current Status/ Work Completed to date
A7.1	Short-Long Term	The consolidation of facilities delivers synergies and economies of scale that make service and information provision more viable and accessible to the community	Murrindindi Shire Council Department of Planning and Community Development. Department of Health	Recognise the Design Frameworks contained in this document in the Murrindindi Planning Scheme	1.3, 4.1, 4.3, 5.4, 7.3	Not possible to reference or incorporate the study into the Murrindindi Planning Scheme until such time as the study is completed and officially adopted by Council. <u>Recommendation</u> Action to remain as is.
A7.2	Short – Long Term	The ability of pedestrians, cyclists and horse riders to travel safely within the study area is limited by the lack of off road trails in some locations	Murrindindi Shire Council VicRoads	Allocating funding in Councils capital works budget	3.3, 3.5, 5.1, 5.4, 6.1, 7.1, 7.3.	Council has been completed or progressed several recent projects in the study area including: Flowerdale – new working/cycling path connecting Flowerdale community with Spring Valley Rec Reserve Flowerdale – reconstructed walking/cycling path connecting school and residential areas (to Riverside Drive) Kinglake – new walking/cycle path connecting Kinglake to Kinglake Central and community facilities in Extons Rd Kinglake West – reconstructed and extended walking/cycling path between KW and Kinglake Central (effectively connecting KW to Kinglake) Kinglake History Art Walk – grant funding announced Kinglake to Mt Slide walking path – to commence construction 2012/2013 Toolangi Tall Trees Trail – 7km multipurpose (walk/cycle/horse) trail constructed around Toolangi

							<p><u>Recommendation</u></p> <p>Revise action taking into consideration works already completed / underway.</p>
A7.3	<p>Explore opportunities to improve all telecommunications (telephony, television, radio, wireless and broadband) access within the Shire of Murrindindi.</p> <p>Investigate the revised governing frameworks around the rollout of the National Broadband Network and develop a positioning strategy to prioritise rollout in the region</p>	Short – Medium Term	Improved telecommunications will provide greater local connectivity and information, better support networks, greater support for business, opportunities to work at home and reduce travel to work and improve safety during emergencies	Murrindindi Shire Council State Government	Lobby the National Broadband Network Co. and telecommunication s providers to provide improved infrastructure to the area	2.2, 2.5, 3.3, 5.3, 5.4, 6.1, 6.2, 7.2, 7.3.	<p>NBN Fibre rollout to commence in area of Kinglake to Kinglake West within 3 years.</p> <p>Council currently in discussion with NBN Co concerning the fixed wireless NBN roll out in the Shire, including other parts of the study area (Toolangi and Flowerdale)</p> <p><u>Recommendation</u></p> <p>Action to be revised on basis of current NBN rollout plans for the study area.</p>
A7.4	Develop and implement local information strategies which utilise a range of media, including community noticeboards (hard copy and electronic) access to on-line information and staffed information at Kinglake Town Centre.	Short – Long Term	Improved delivery of information will result in a more informed and engaged community	Murrindindi Shire Council	Council Communications Strategy	1.3, 5.1, 5.2, 5.4, 6.1, 6.2, 7.3.	<p>Council has installed community noticeboards in towns within the study area.</p> <p>Council has an existing communications strategy and protocols that includes the study area.</p> <p><u>Recommendation</u></p> <p>Action to be reframed to reflect need for implementation and continuous improvement of current strategy for the study area.</p>
A7.5	<p>Explore opportunities for improved and alternative public and community transport within the study area and improved connections to key local, regional and metropolitan destinations</p> <p>Work with local business and community service providers to promote the role and potential of existing community transport facilities to enhance local access (e.g. Regular community bus link to retail and community facilities)</p>	Short – Long term	Providing greater variety of transport options better linked to destinations will support social and economic well-being	Murrindindi Shire Council Department of Transport Hume Region	To be determined	1.3, 3.3, 5.1, 5.2, 5.3, 5.4, 7.1, 7.3.	<p>Public transport trials connecting the Kinglake Ranges to metropolitan centres are under trial by the Dept. of Transport .</p> <p>The Transport Connection Project has highlighted a number of these issues and work is currently being focused on:</p> <ul style="list-style-type: none"> - Improving access to health services - Local innovations projects including Youth Commute and Community Connect with the aim of utilising existing transport infrastructure to resolve issues of access for young people and older adults. <p><u>Recommendation</u></p> <p>Action to be revised to reflect action completed to date.</p>

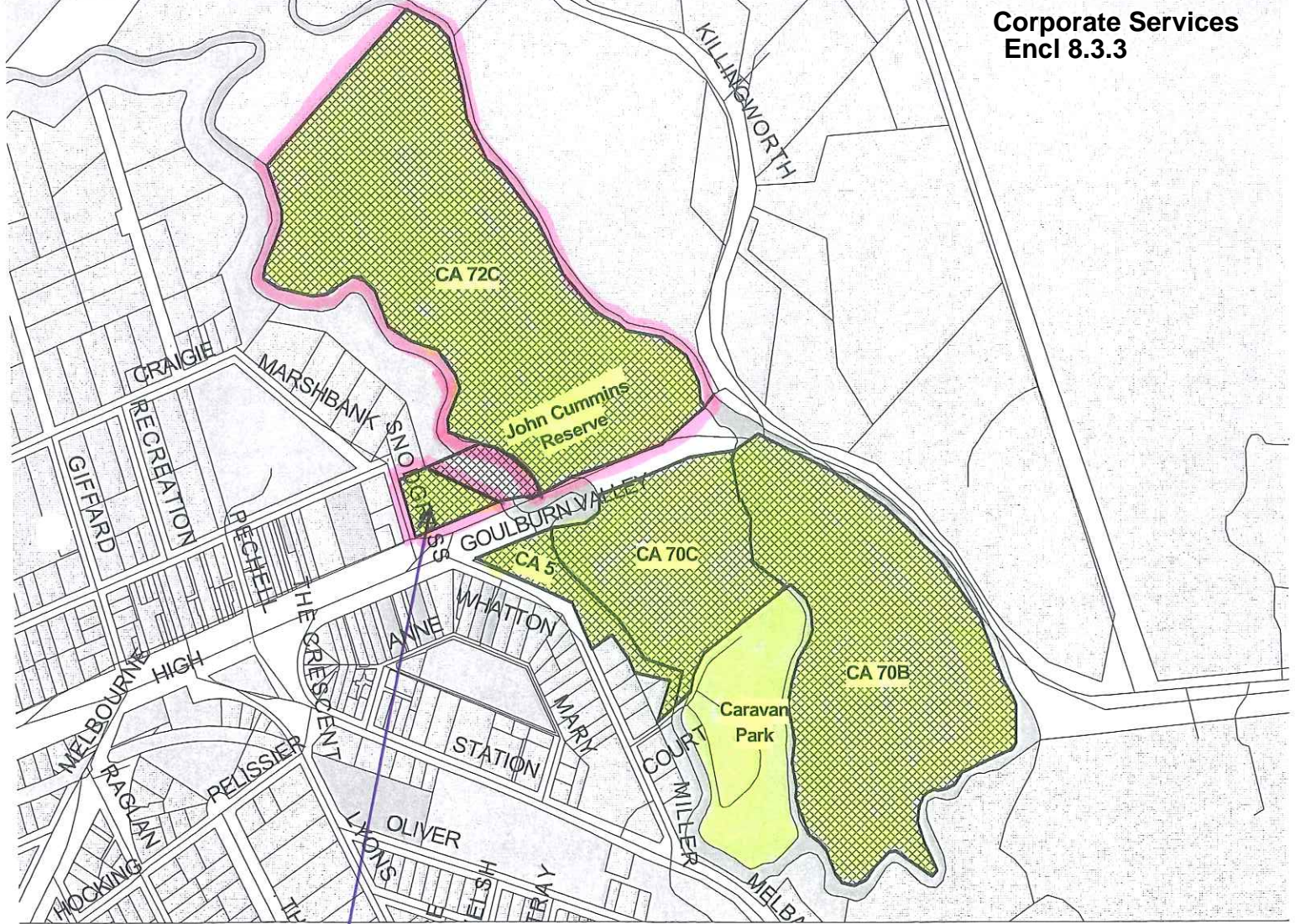

AREA TO BE EXCISED

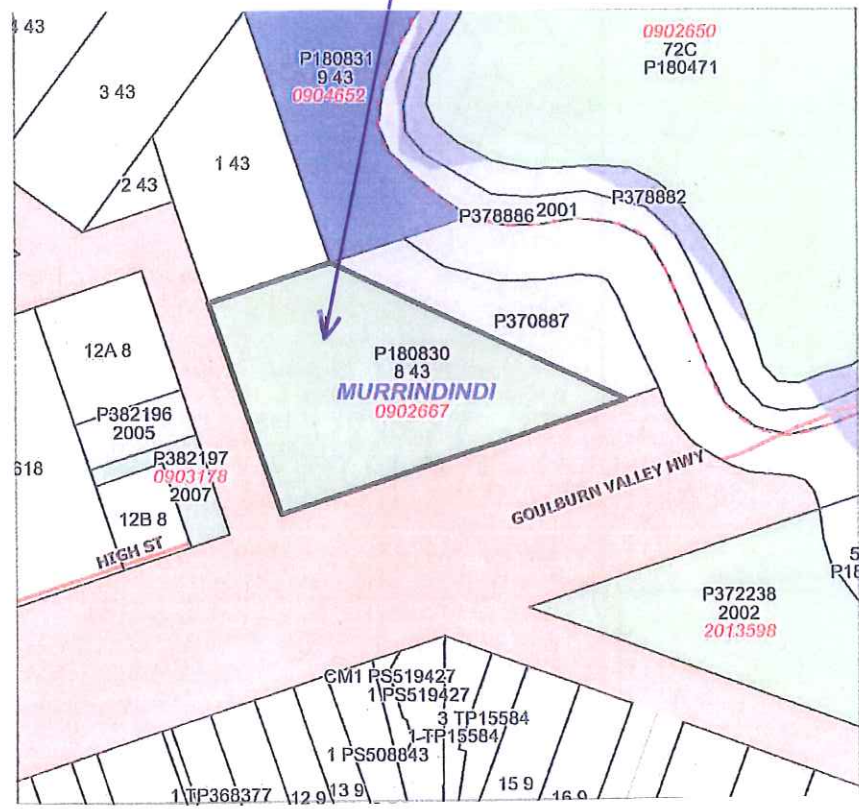

COUNCIL
AS COM



EXISTING
DELEGATION
Y W COM



Y WATER CENTRE

Murrindindi Shire Council Policy

Title: TOWNSHIP ENTRANCE and COMMUNITY EVENT FRAMES GUIDELINES

Type: Council

File No: 58/06/20-1

Date Adopted: 24 July 2013

Next Review Date: July 2017

Revision History:

Date	Action	Who
26 October 2011	Adopted	Council
24 July 2013		

1. Purpose

To assist Council or its nominated community group to manage event promotion on town entry signage and service/club signage.

2. Rationale

This policy allows for the positive promotion of events and activities across the shire.

3. Scope

It is Council policy that the promotion of local events be facilitated through the availability and usage of temporary banner signs and corflute runners at Alexandra, Eildon, Kinglake, Marysville, and Yea. In accordance with the procedure below, Council will permit appropriate signage to be erected free of charge for a reasonable time before an event.

4. Policy

Murrindindi Shire Council has township signage that enables banners to be attached to promote community events and activities. Associated with this signage are 14 dedicated service/clubs/events frame in the shire's five service centres of Alexandra, Eildon, Kinglake, Marysville and Yea.

These frames have been designed to accommodate a single banner as well as a bracket to support a slide in corflute (or similar) sign. The frames have been erected to eliminate signage clutter that arises on the road reserve at township entrances, particularly during peak event periods. The township entry sign frames have been designed to hold a single banner, while the community service club frames have been designed to host a banner and slide-in sign. That enables Alexandra, Eildon, Marysville, Kinglake and Yea to effectively promote three single events at one time.

4.1 Eligibility

1. Events signage will be managed by respective traders, tourism or progress associations in Alexandra, Eildon, Marysville, Kinglake and Yea.
2. Space is only available for the promotion of tourism and community events. Priority should be given to tourism events. A tourism event is defined as a short-lived, organised activity designed to attract visitors from outside the region so they may participate, watch, view, learn from and enjoy. Tourism events are organised activities that enhance an existing site, city or attraction and aim to entertain existing tourists, stimulate new visitation and encourage repeat visitation and extend length of stay. This could also be major events carried out on a regular or annual basis attracting large crowds which are conducted over one day or a number of days e.g. race meetings, expos.

3. Banners promoting local not-for-profit, non-commercial educational, cultural, religious, social community or recreational events or services within the shire may be displayed when tourism event banners are not being displayed.
4. Businesses are eligible to apply to advertise tourism events only; however preference will be given to events run by community groups and significant large “short lived” events.
5. In the event of disputes in Alexandra, Eildon, Kinglake, Marysville and Yea, they will be referred to a panel comprising of Council's Manager Economic Development and General Manager Sustainability.
6. Disputes emanating from smaller townships will be based on time of lodging events through Council's event enquiry checklist
7. Community organisations appointed by Council to control event signage requests will have permission to remove any signage if it does not meet the content of these guidelines.
8. While Council recognises the costs associated with some signage, refusal and removal of signs will take place if they are not of a “professional” nature. Hand drawn signs on cardboard will not be accepted.
9. Signs that contain offensive language or pictures will be removed.

4.2 Costs

1. There will be no fee to attach banners to the respective signs.
2. Cost associated with the production of signs will be borne by events committees and organisers.
3. It is the responsibility of the organising committee to install and remove their event signs at no cost to Council or community organisations who have been delegated responsibility.

4.3 Timing

1. Signs may be installed up to 14 days prior to an event, depending on availability, and must be removed within 24 hours of the events completion. Failure to do so may result in the event being ineligible for signage display in subsequent years.
2. Events running longer than three days, e.g. exhibitions, may be eligible to utilise the event board for longer than the prescribed period of 14 consecutive days. These events will only be eligible at the discretion of the delegated organisation.

4.4 Regular events

1. Organisers of regular/monthly events may apply for a space on the event frames for each of their events. However monthly events will only be granted space if a community group/not for profit event or large “short lived” event has not applied for space at the time of the event.
2. Monthly events may only install their sign seven days before the event date.

4.5 Booking system

1. Event organisers are asked to contact respective associations in Alexandra, Eildon, Kinglake, Marysville and Yea to book signage space at least one month before their event. An Event Enquiry Checklist should also be provided to Council.
2. Space will be allocated at the discretion of the delegated association. As outlined above, community groups/not for profit events, tourism events or major events will have priority.
3. In the service centres, the designated events signage board must be the priority to place banners/signs in the first instance.

4.6 Signage

1. Signage banners are interchangeable at major towns. That is if a banner is developed 900mm, it can fit both the “welcome to” and “service organisation” signage.
2. Corflute signage needs to be 400mm in height and up to 2700mm in width.

3. Small Town "Welcome To" signs can accommodate a 1200mm x 900mm banner.
4. No commercial advertising is permitted.
5. Sponsor logos, not for profit groups and Council logos will be permitted on banners.
6. Dates of the events should be listed on the signs unless the sign shows, for example "First Sunday of each Month" or "Next Sunday" etc. In the event that the words, for example "Next Sunday" are used then only six days advertising is allowed. This means six days prior to the day the event is on. This will be at the discretion of Council/ delegated committees.
7. Banners must be securely fixed in place and maintained in good order during the display period.
8. The frames cannot be used for political purposes.
9. Committees/ community groups delegated to look after signage will have the ability to place "tourism" type displays on frames when not being used to promote events.

4.7 Delegated Signage contacts

- Alexandra: Alexandra Visitor Information Centre.
- Eildon: Eildon Action.
- Kinglake: Kinglake Ranges Business Network
- Marysville: Mystic Mountains Tourism
- Yea: Yea Business and Tourism Association

4.8 Risk associated with using the corflute runner

WORKSAFE VICTORIA COMPLIANCE CODES: GUIDELINES FOR PREVENTION OF FALLS, WORKING AT HEIGHTS NOT EXCEEDING TWO METRES

Hazard: Performing a task from a stepladder

68. Most ladder-related injuries occur as a result of falls from low heights.

Sideways tipping is the cause of most stepladder injuries, and this risk increases as the worker ascends the ladder. In this case, the worker is working above the second tread from the top of the ladder and is at extreme risk of falling.

The worker is often working alone and does not have anyone to hold the stepladder to stabilise it.

Solution: Use a step platform

69. A commercially available step platform provides a safer alternative to a stepladder, especially where the task involves working at height for extended periods or restricted vision (such as welding or other hot work). The step platform is extremely stable and provides a much larger work surface than the step ladder. Some models are collapsible.

Portable ladders

Except where additional and appropriate fall protection equipment is used in conjunction with the ladder, any person using a ladder should not:

- face away from the ladder when going up or down, or when working from it
- stand on a rung closer than 900mm to the top of a single or extension ladder
- stand higher than the second tread below the top plate of any stepladder.

People using ladders should not:

- handle or use ladders where it is possible for the person or the ladder to make contact with powerlines
- use a stepladder near the edge of an open floor, penetration or on scaffolding to gain extra height
- over reach (the worker's belt buckle needs to remain within the ladder stiles throughout the work)

File:X:\Corporate Services\Council\2013\Council Meetings\2013_07_24\Attachments\COMMS - Event signage policy Attach.docx	Page 3 of 4
Author: Murrindindi Shire Council	Created: 19/06/13 4:49:00 PM Last saved: 17/07/13 1:26:00 PM
Comment:	Last saved by: kenneilm Last printed: 17/07/13 1:26:00 PM

- use any power (air, hydraulic, electric or battery) equipment or tool specifically designed to be operated with two hands and which may require the operator to brace themselves against the high level of torque exerted by the tool
- carry out work such as arc welding or oxy cutting, unless step platforms or other temporary work platforms are not feasible and the task is of short duration and a safe work procedure is followed
- use tools requiring the use of both hands and dynamic movement, such as axes and crowbars
- use tools that require a high degree of leverage type force (such as “Stillsons” or pinch bars) which, if released may cause the user to overbalance or fall from the ladder
- work over other people
- allow anyone else to be on the ladder at the same time.

A ladder must be set up on a surface that is solid, stable and secure. It must also be set up to prevent it from slipping.

PLEASE NOTE:

If a step platform is not available for use when placing corflute signs in the structures at Alexandra, Eildon, Kinglake, Marysville and Yea, then two people should attend, one to climb the ladder and the other to hold the ladder, while placing the event signage.

5. Supporting Documents

Council Plan 2013-2017:

Our Economy: We will increase the economic, social and cultural benefits to the Shire of a growing tourism sector.

Our Community: We will encourage inclusive, creative and resilient communities

Our Community: We will actively engage with our communities to increase participation and community input

6. Related Policies

Risk and safety Policy
Tourism Policy

7. Governance

This policy will be monitored by the Manager Communications and Customer Services.

8. Portfolio and/or Riding Councillor Input

Not applicable

9. Responsible Officer

Manager Communications and Customer Services

10. Human Rights Charter

This policy has been developed with consideration of the requirements under the Charter of Human Rights and Responsibilities.